

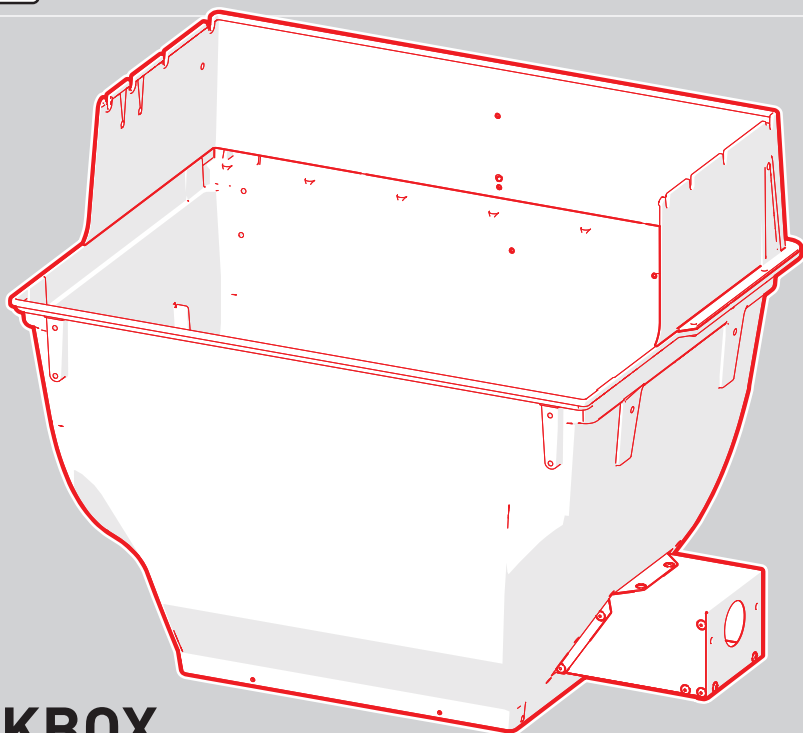

Searwood



COOKBOX REPLACEMENT INSTRUCTIONS

⚠ DANGER! HAZARDOUS VOLTAGE IS PRESENT WITHIN THE GRILL AND CAN SHOCK, BURN OR CAUSE DEATH. ALWAYS UNPLUG THE GRILL FROM THE POWER SOURCE BEFORE SERVICING OR CLEANING.

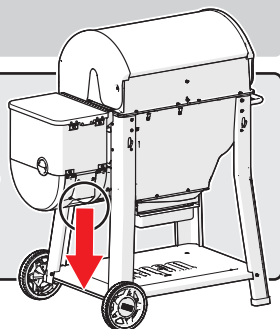
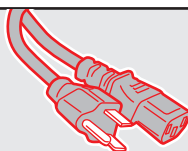

⚠ CAUTION: MAKE SURE GRILL IS OFF AND COOL BEFORE BEGINNING ANY REPAIR.

NOTE: Grills illustrated may differ slightly from model purchased.

8651393 EN_090323

⚠ WARNING: REMOVE ALL PELLETS FROM THE HOPPER.
REFER TO YOUR OWNER'S GUIDE FOR MORE DETAILS.



1

COOKBOX COMPONENTS REMOVAL

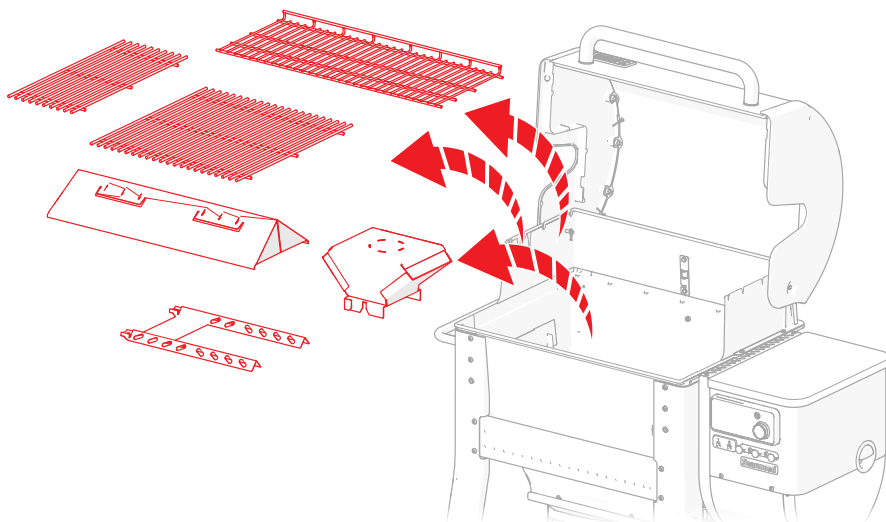

2

BURN POT REMOVAL

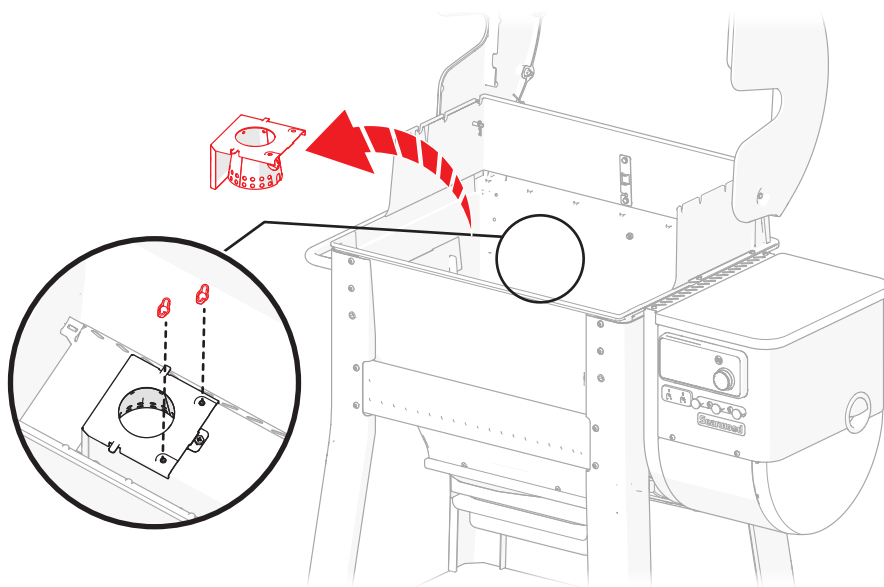



Hardware may be different on the grill you have,
please use appropriate tool.

3

LID REMOVAL

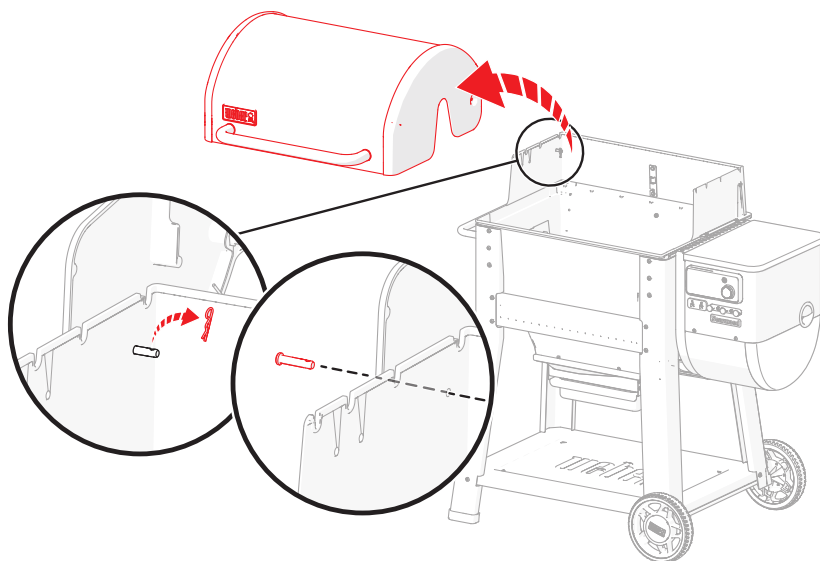

4

DISCONNECT GLOW PLUG BRACKET

- Pull the glow plug assembly off and lay it in front of the auger chute

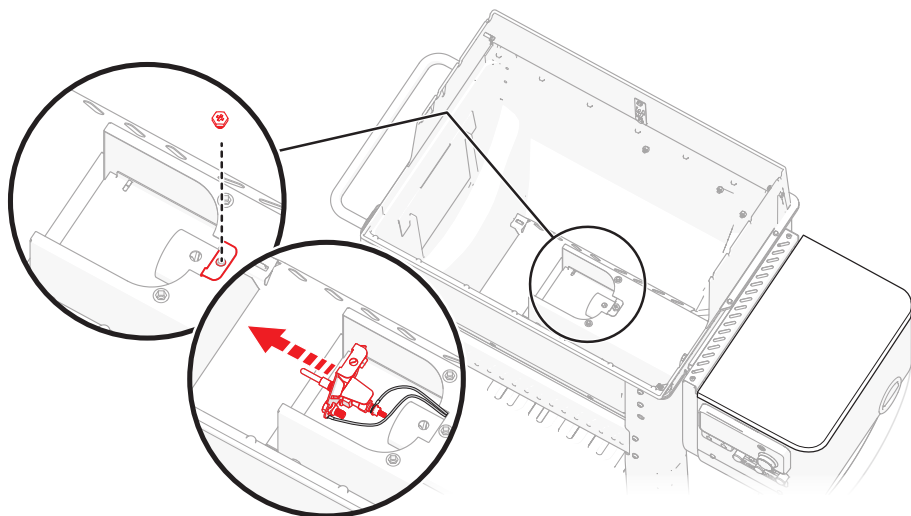

5

FINGER GUARD REMOVAL

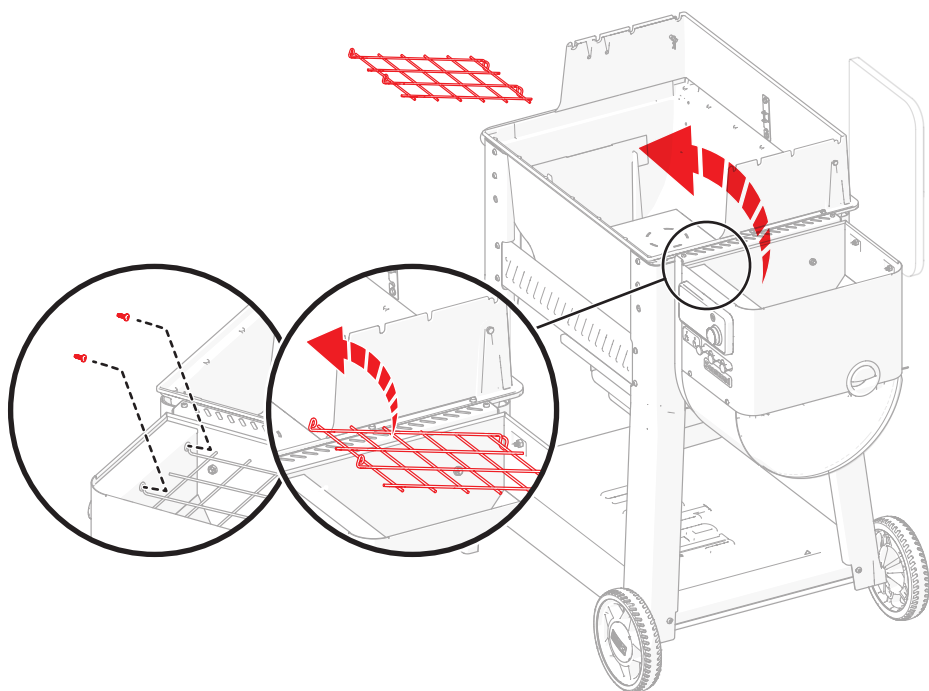
**6**

HOPPER LID REMOVAL

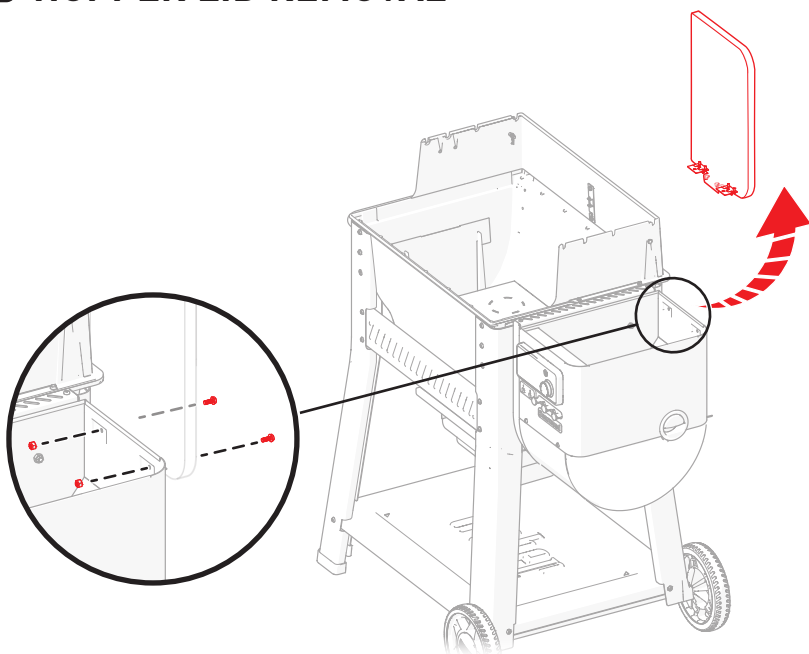

7

CONTROLLER REMOVAL

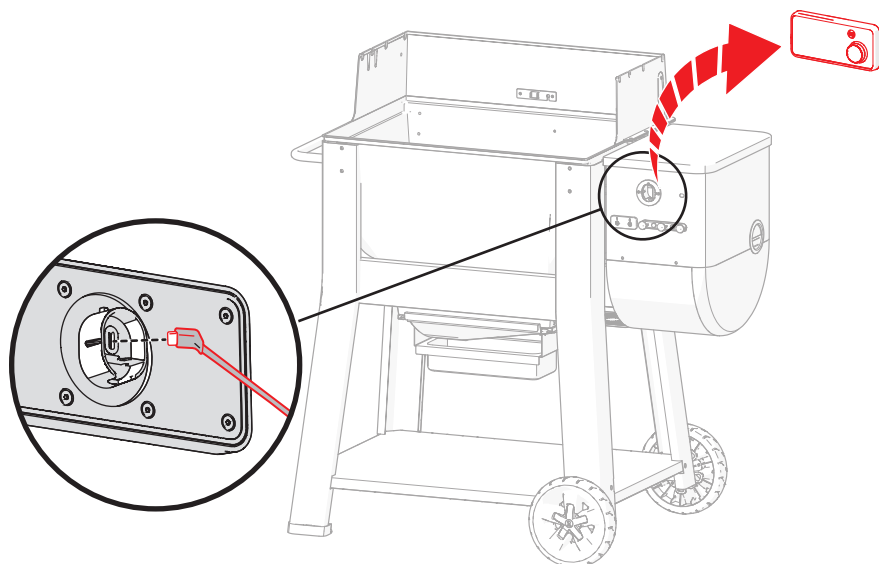
**8**

OPEN HOPPER ACCESS DOOR

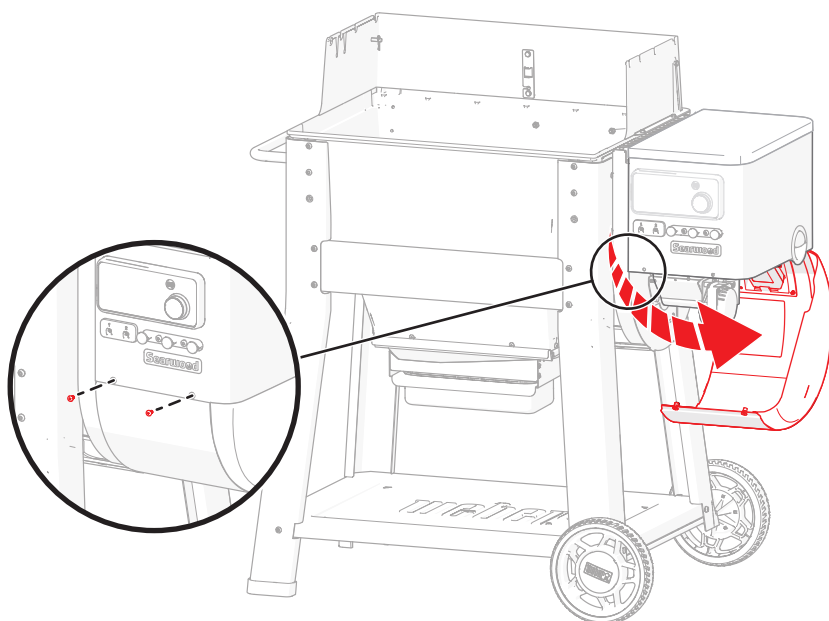

9

UNPLUG CIRCUIT BOARD

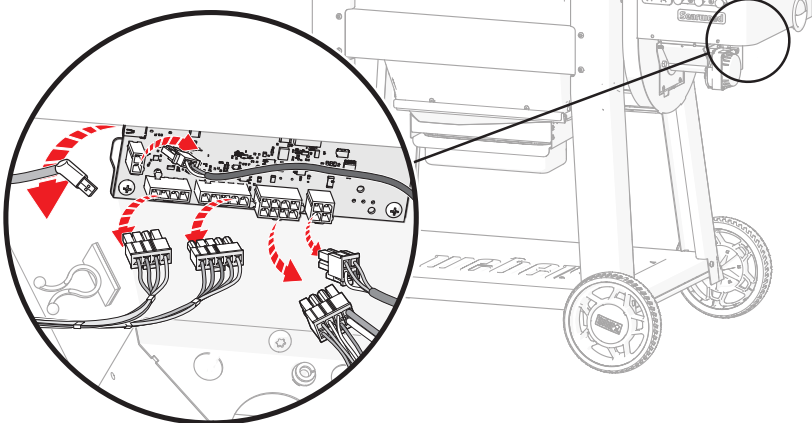

10

AUGER ASSEMBLY REMOVAL

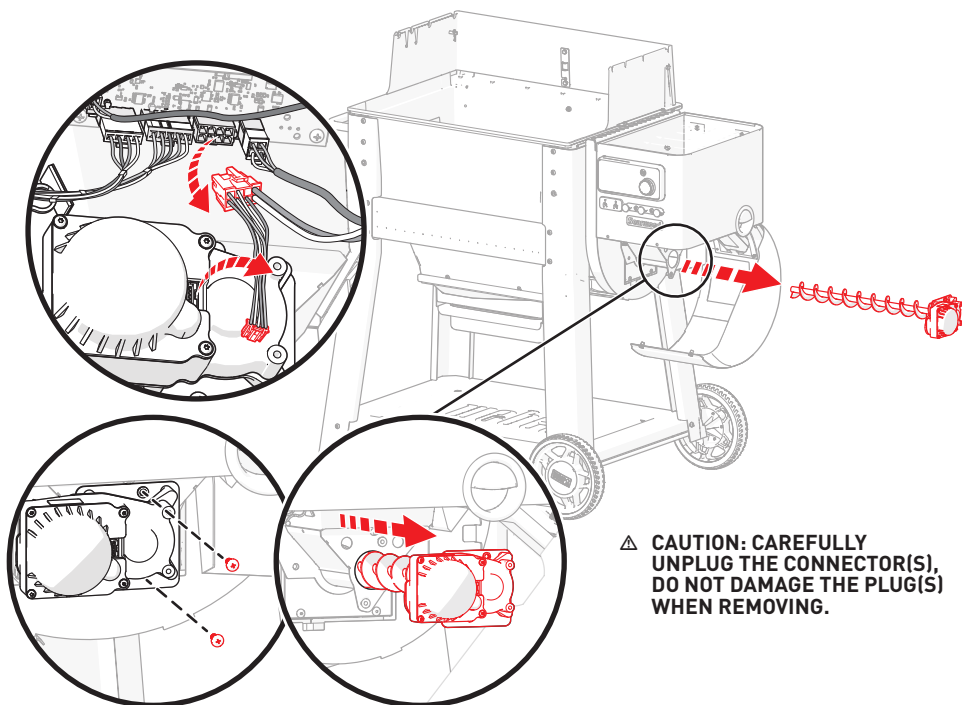

⚠ CAUTION: CAREFULLY UNPLUG THE CONNECTOR(S), DO NOT DAMAGE THE PLUG(S) WHEN REMOVING.

11

FERRITE CLAMP REMOVAL

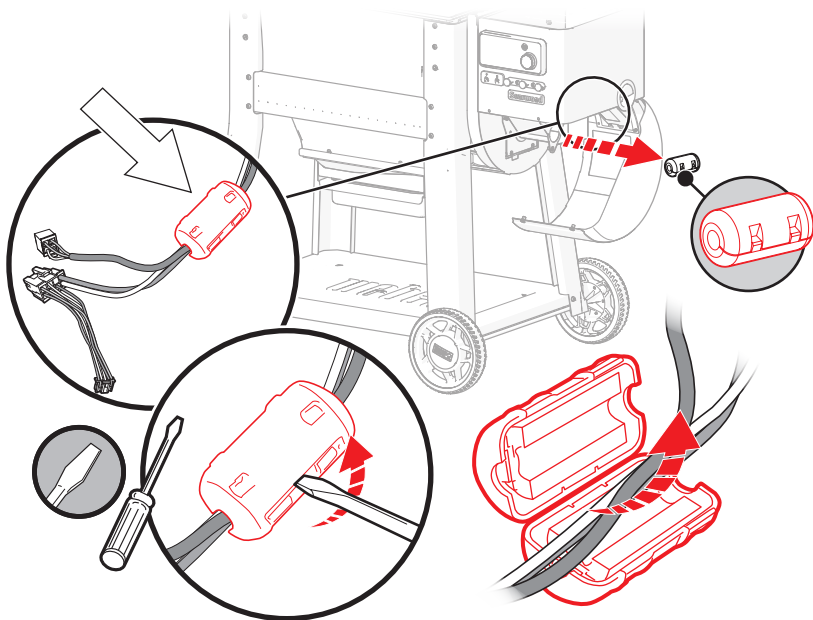
**12**

HOPPER ACCESS DOOR REMOVAL

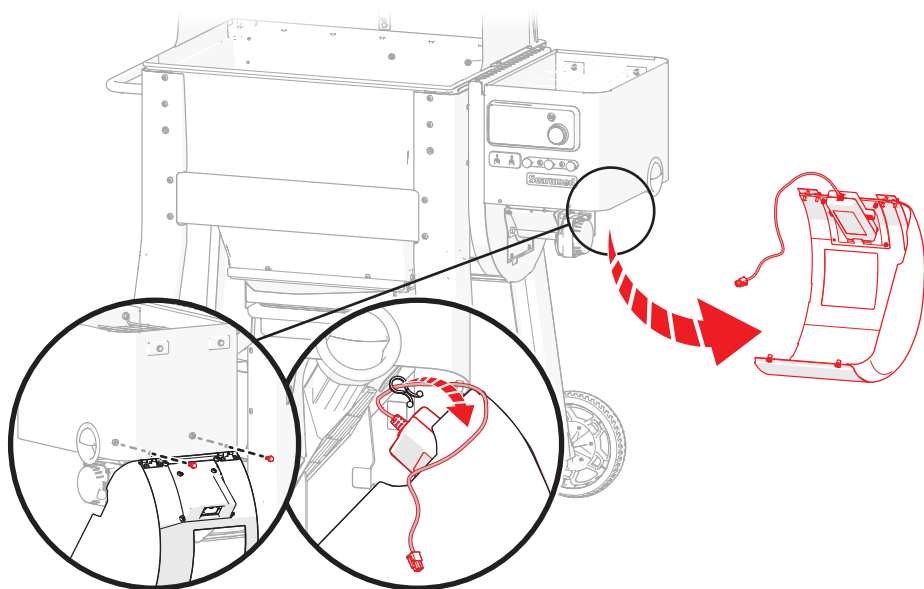

13

HOPPER REMOVAL

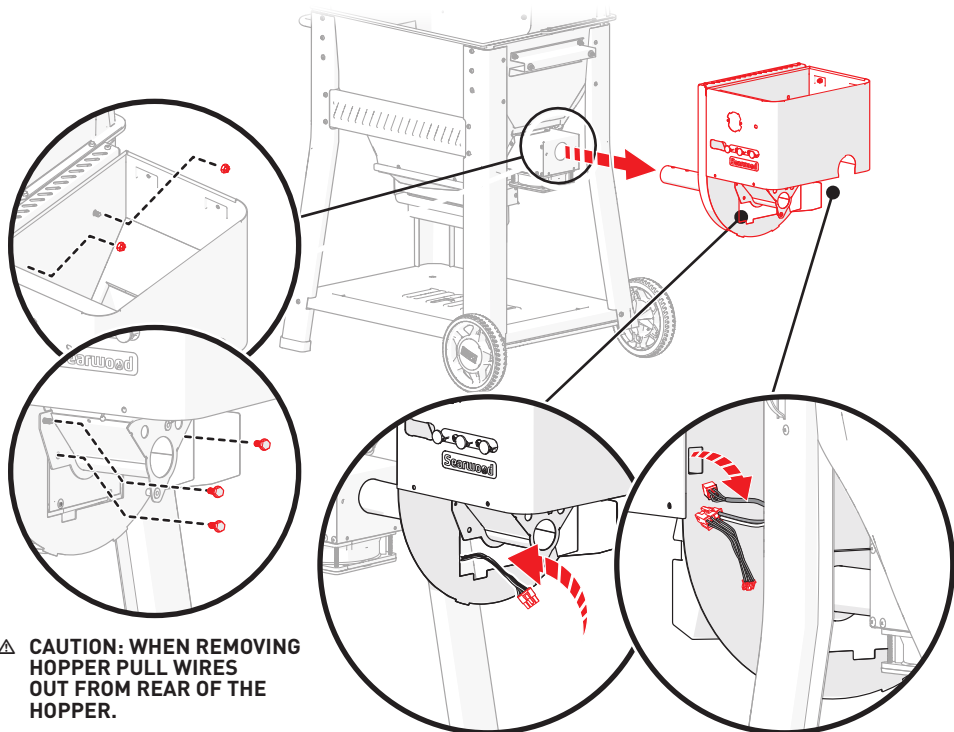

⚠ CAUTION: WHEN REMOVING HOPPER PULL WIRES OUT FROM REAR OF THE HOPPER.

14

THERMOCOUPLE REMOVAL

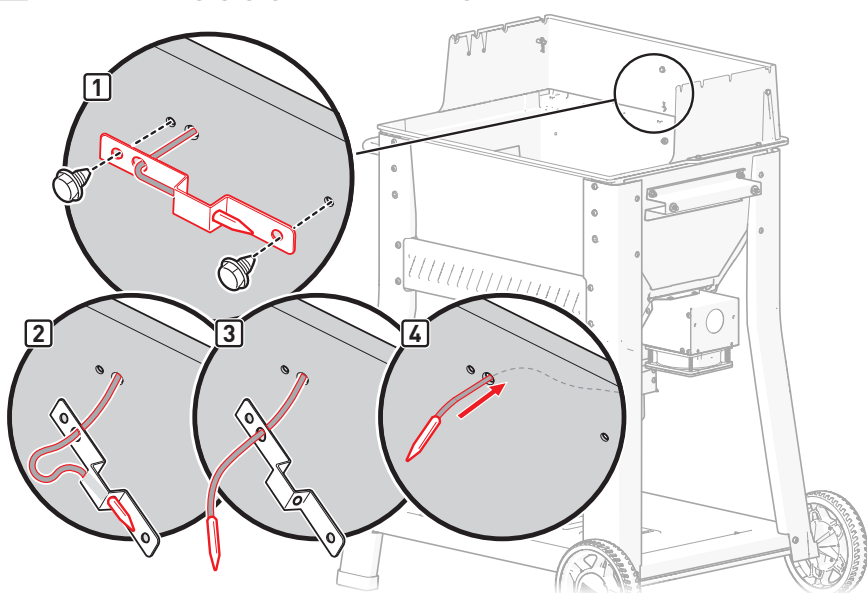

15

GLOW PLUG ASSEMBLY REMOVAL

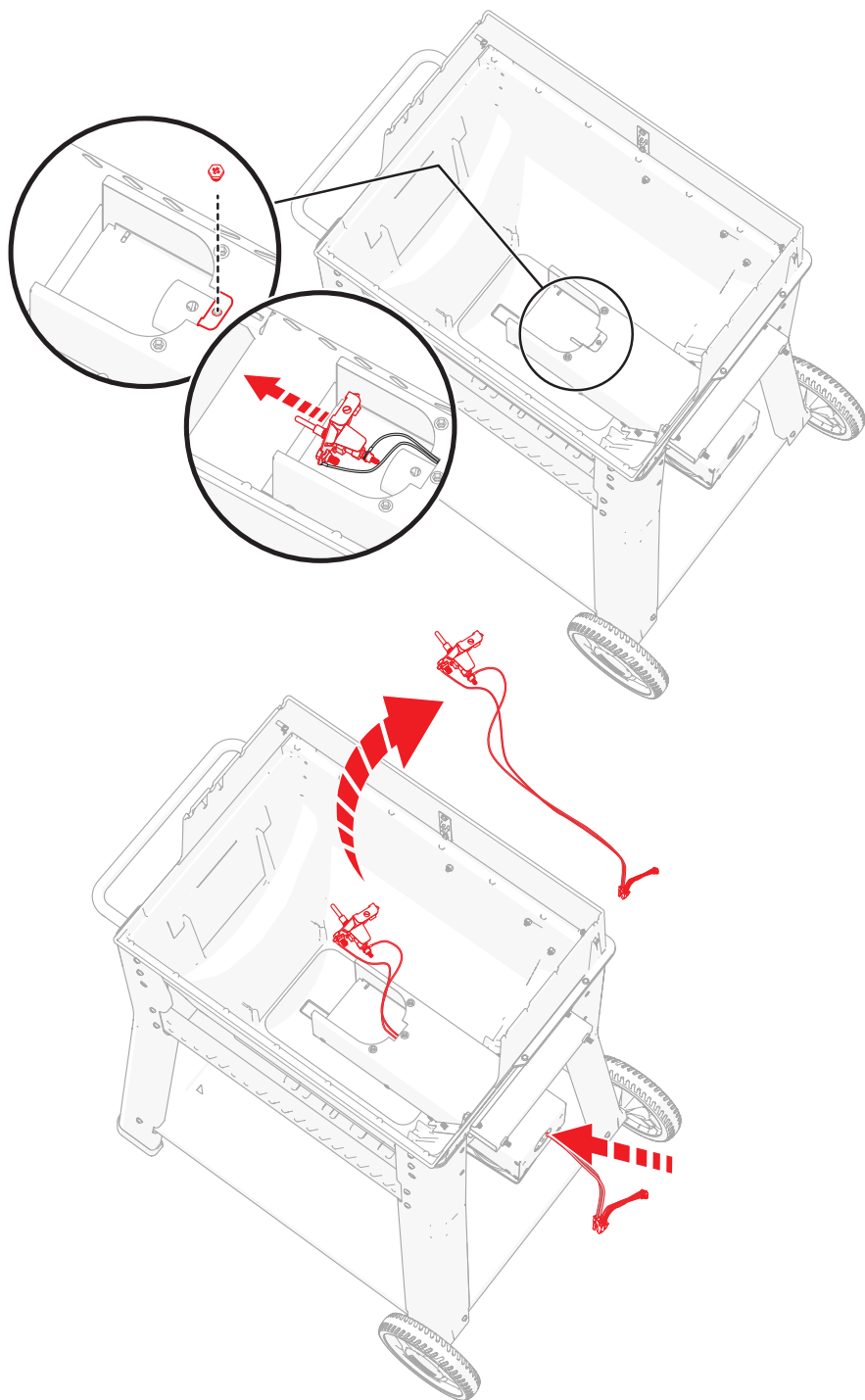

16

HOPPER SUPPORT REMOVAL

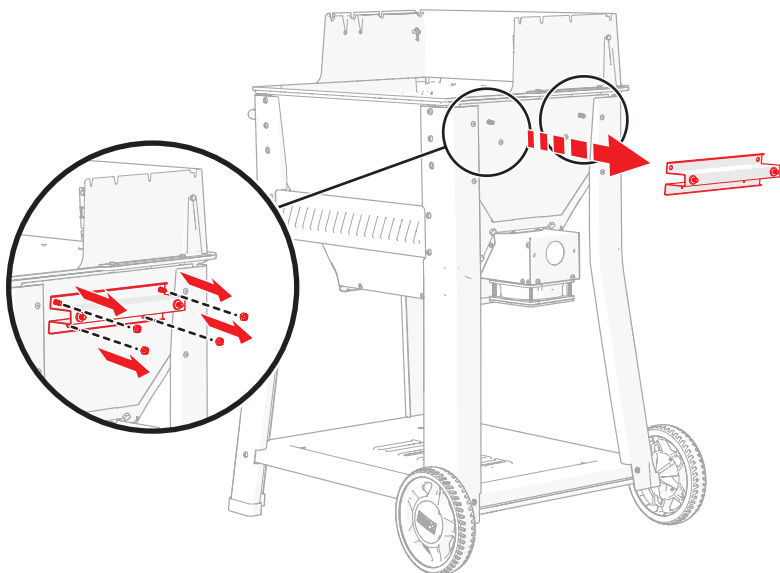
**17**

FAN REMOVAL

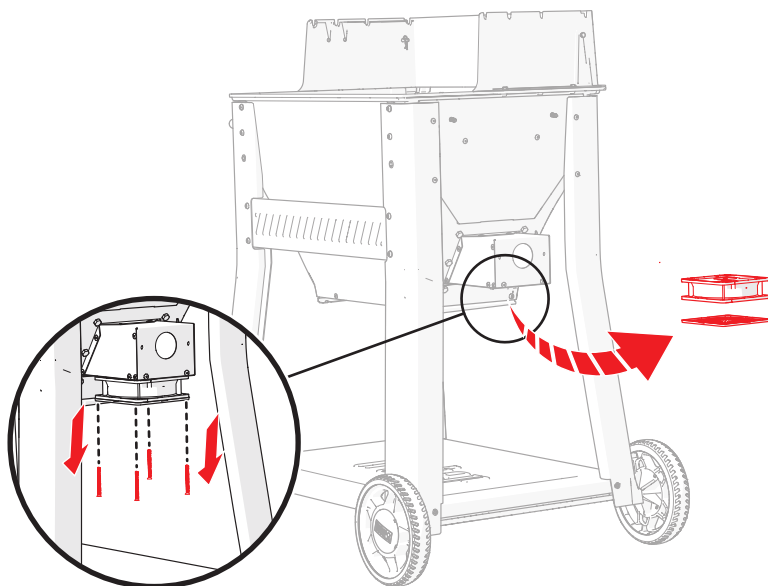

18

FLIP GRILL UPSIDE DOWN

- PLACE THE ENTIRE GRILL ASSEMBLY ON A NONABRASIVE SURFACE WHERE YOU CAN ACCESS ALL OF THE COMPONENTS EASILY.

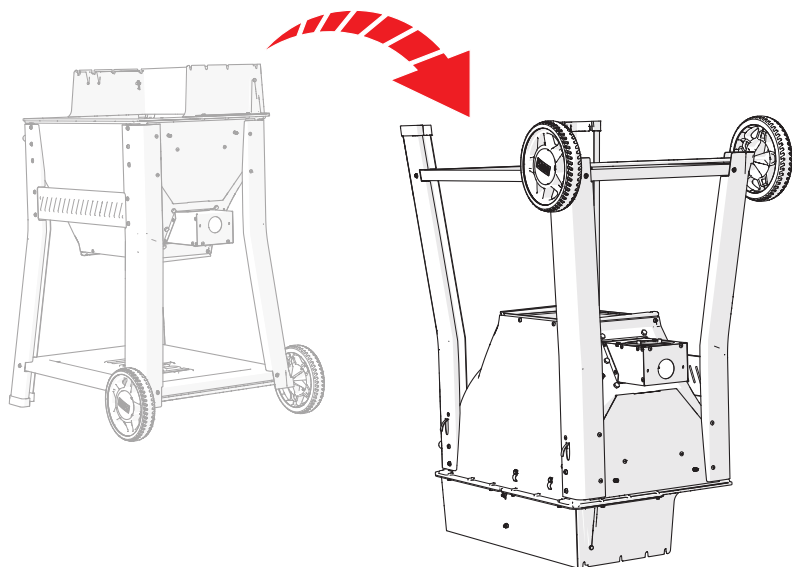

19

WHEEL / AXLE REMOVAL

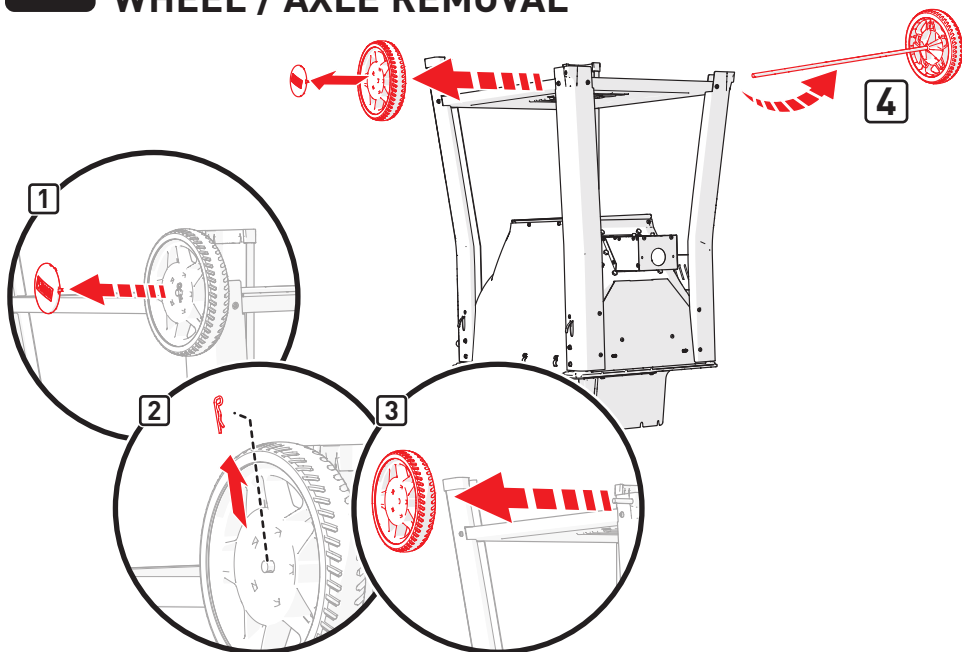

20

REAR WHEEL LEG REMOVAL

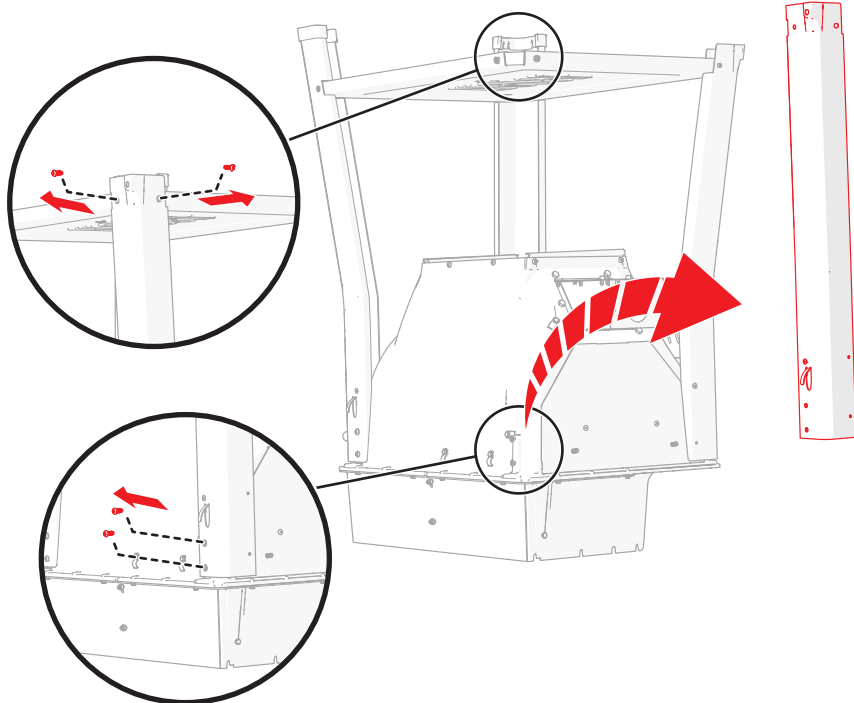

21

BOTTOM PANEL REMOVAL

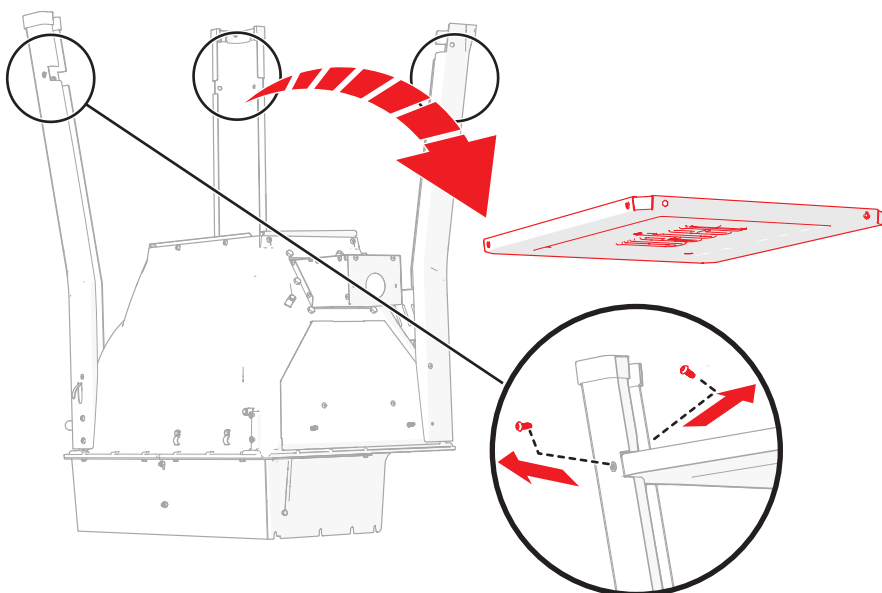

22

SIDE HANDLE REMOVAL

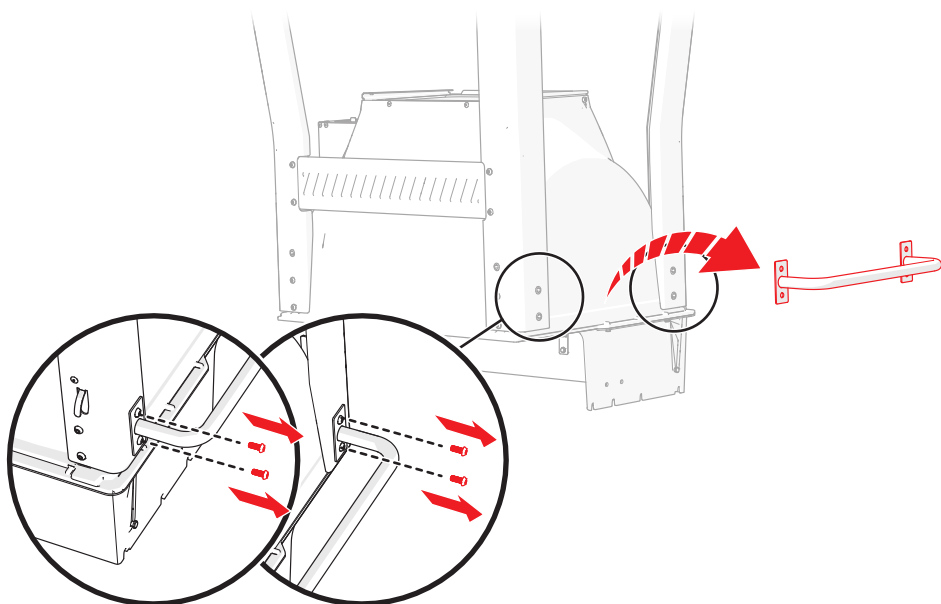
**23**

REAR LEG REMOVAL

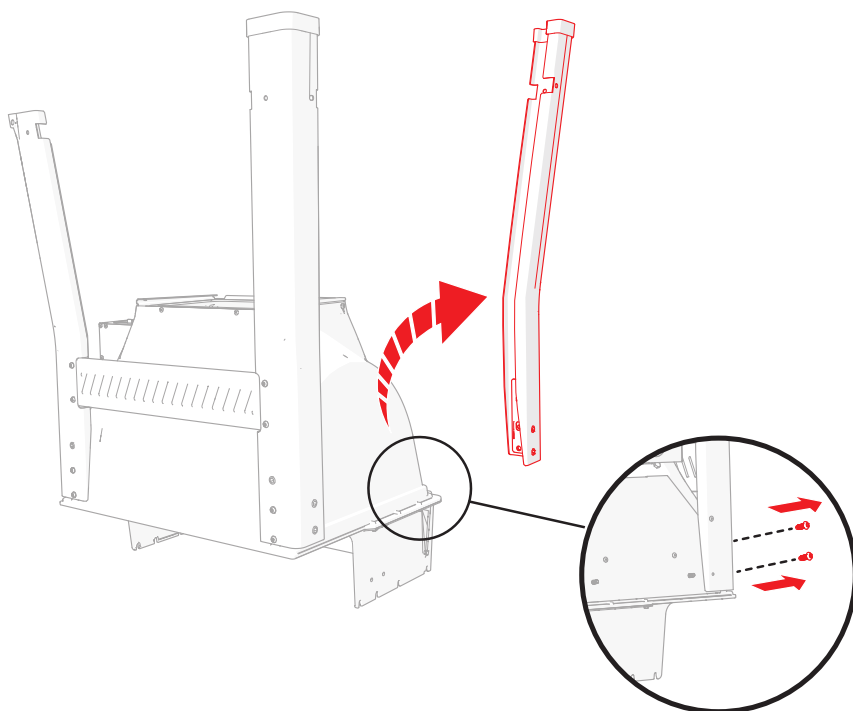

FRONT LEG ASSEMBLY REMOVAL

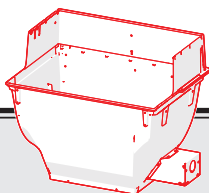
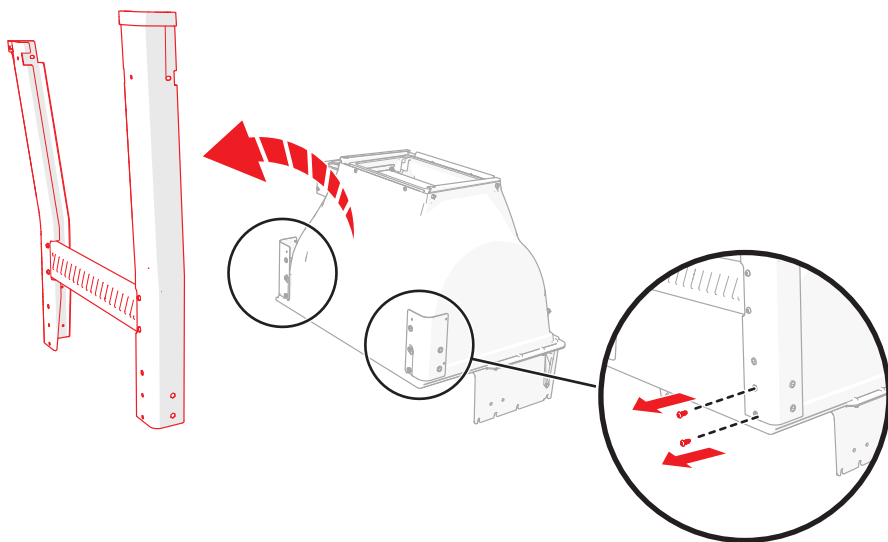

DAMAGED PARTS:

Be responsible when throwing items into the trash, recycle when possible.



⚠ CAUTION: ONLY FINGER TIGHTEN ALL THE SCREWS ON THE FRAME ASSEMBLY, WHILE ASSEMBLING THE FRAME PARTS.

THIS WILL HELP ALIGN ALL OF THE COMPONENTS BEFORE THEY GET FULLY TIGHTENED.

25

FRONT LEG ASSEMBLY RE-INSTALLATION

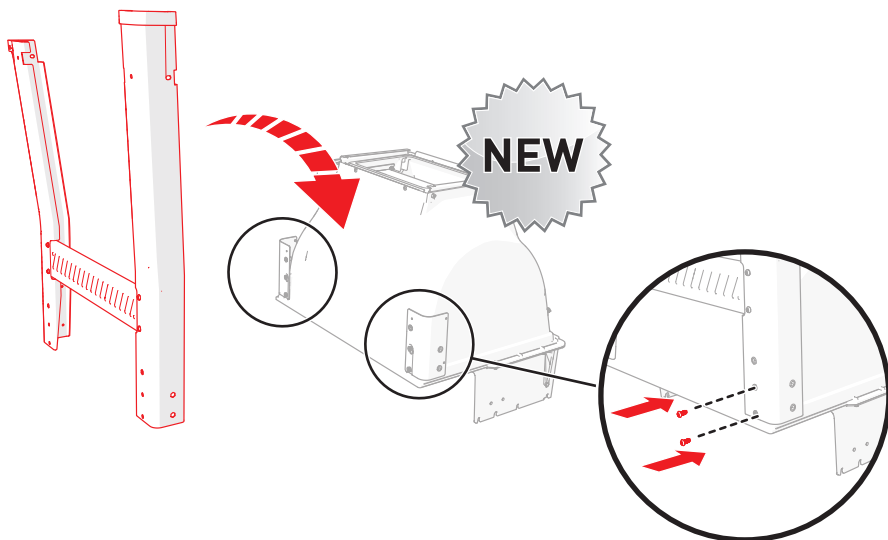

26

RIGHT LEG RE-INSTALLATION

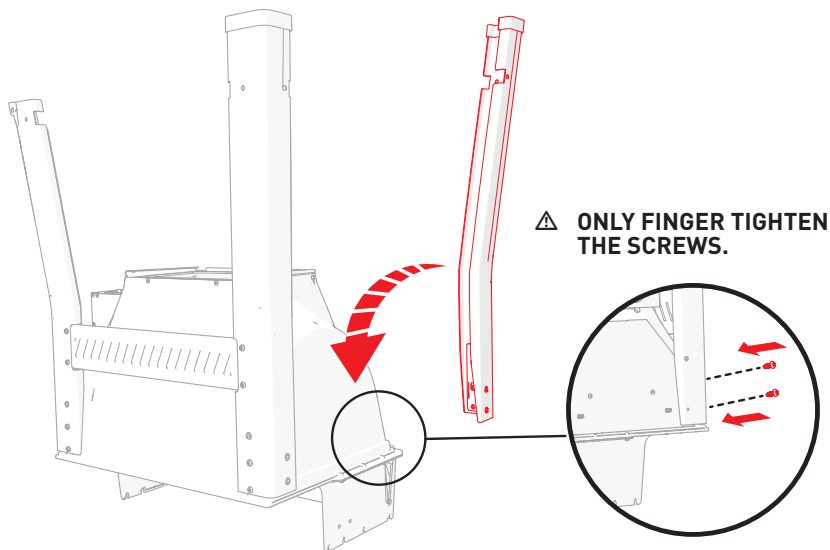

27

SIDE HANDLE RE-INSTALLATION

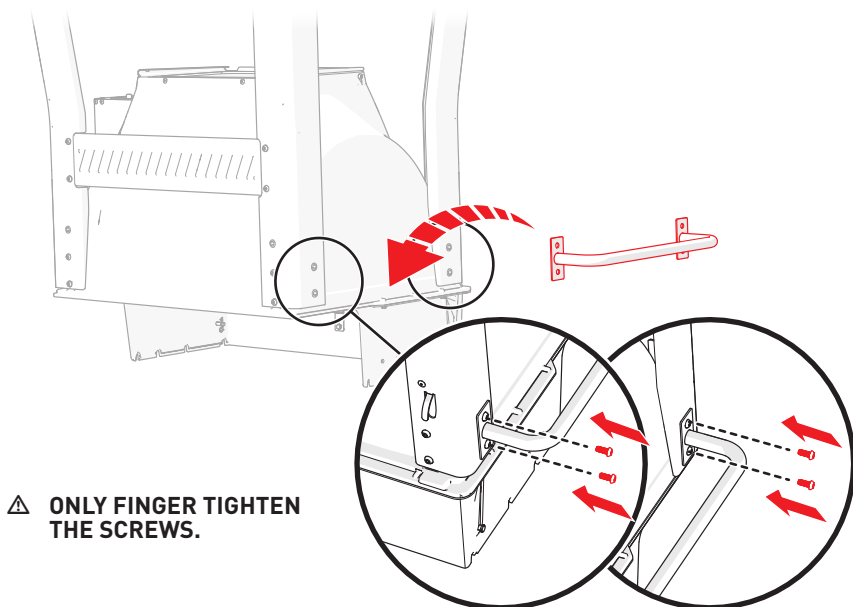

28

BOTTOM PANEL RE-INSTALLATION

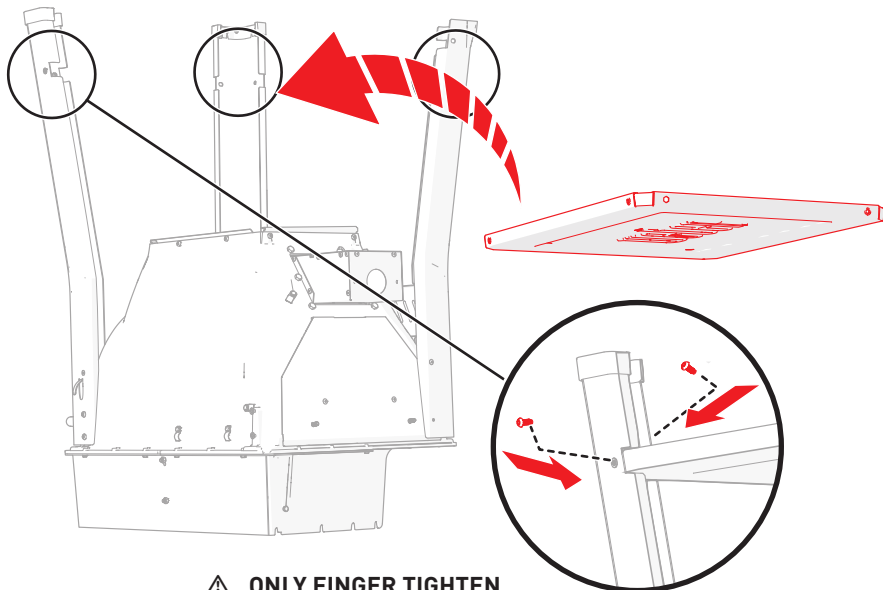

REAR WHEEL LEG RE-INSTALLATION

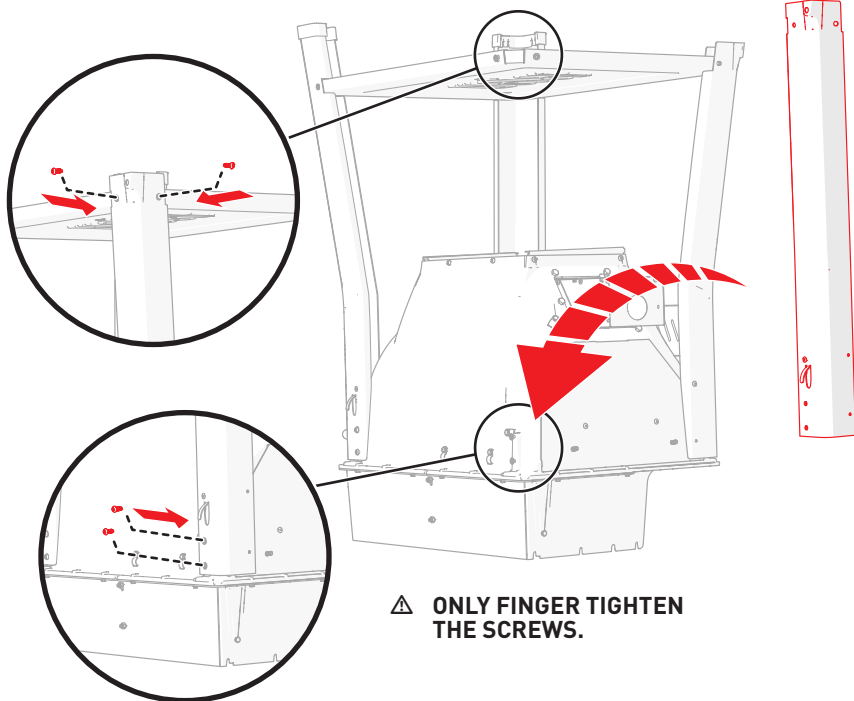

⚠ ONLY FINGER TIGHTEN THE SCREWS.



⚠ CAUTION: FULLY TIGHTEN ALL THE SCREWS ON THE FRAME ASSEMBLY

30

WHEEL / AXLE RE-INSTALLATION

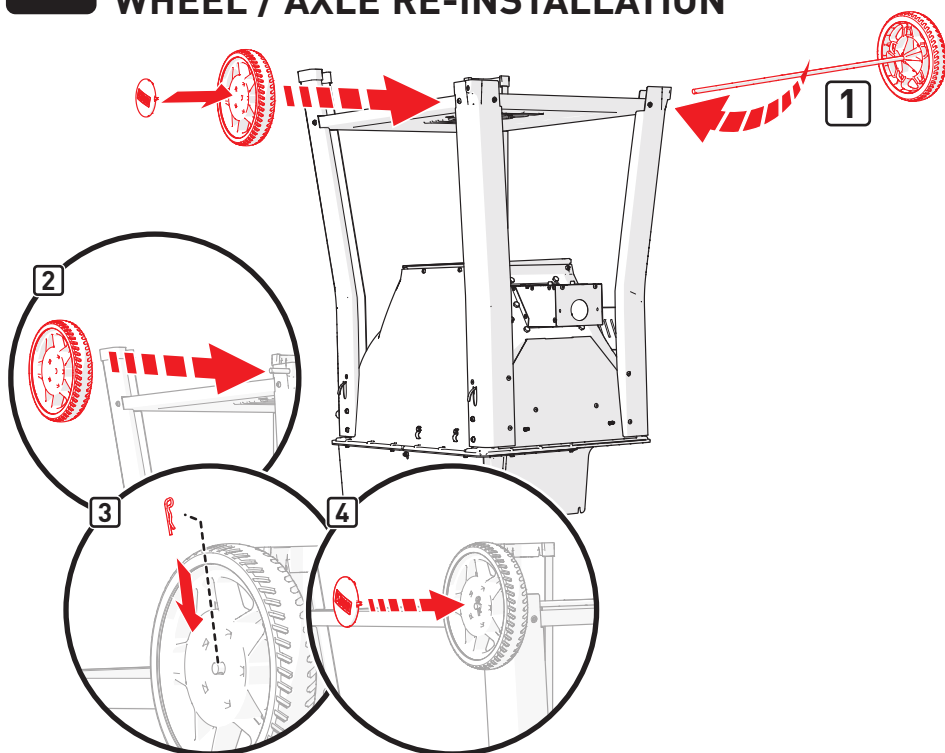
**31**

FLIP GRILL UPRIGHT

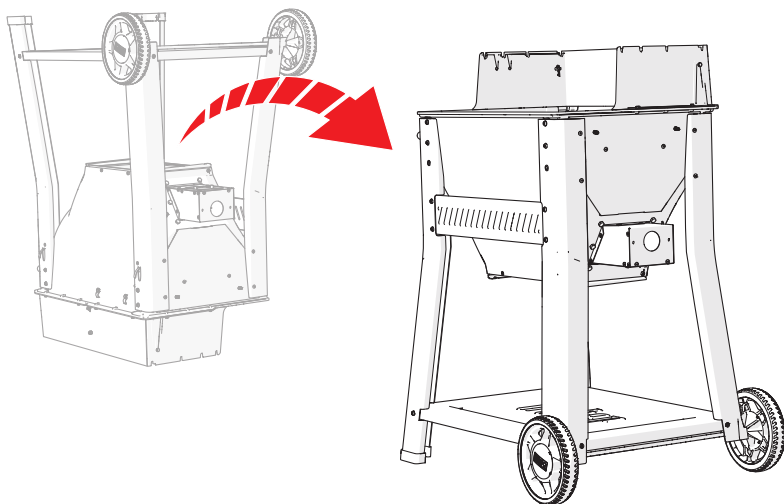

32

FAN RE-INSTALLATION

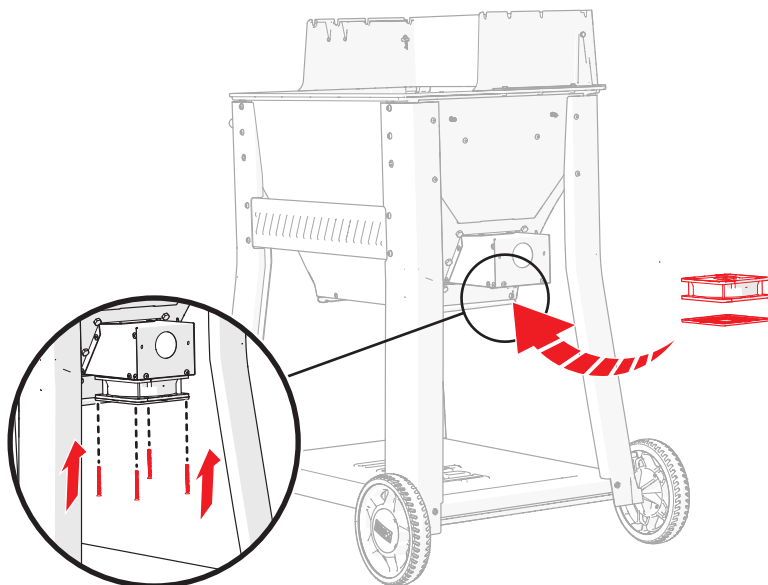

33

HOPPER SUPPORT RE-INSTALLATION

⚠ CAUTION: Make sure the rubber washers are in place before installing the hopper assembly.

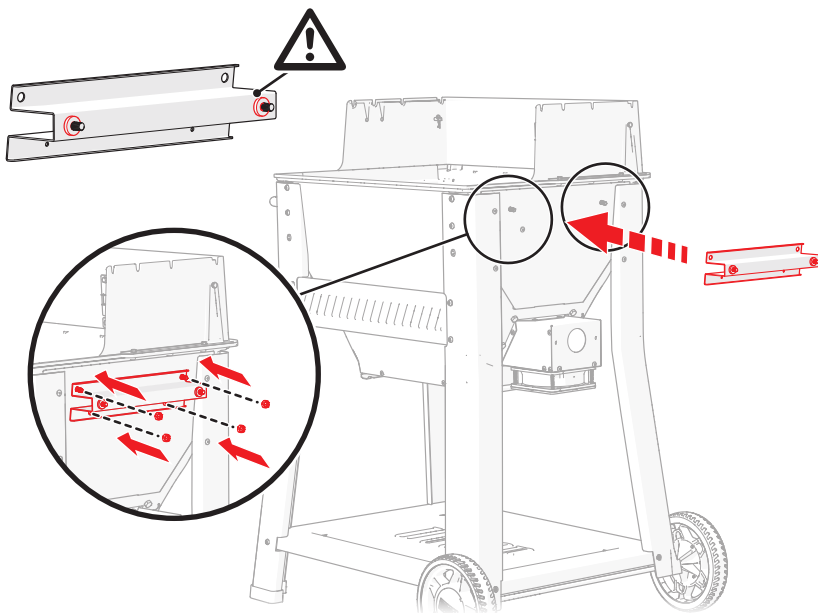

34

GLOW PLUG ASSEMBLY RE-INSTALLATION

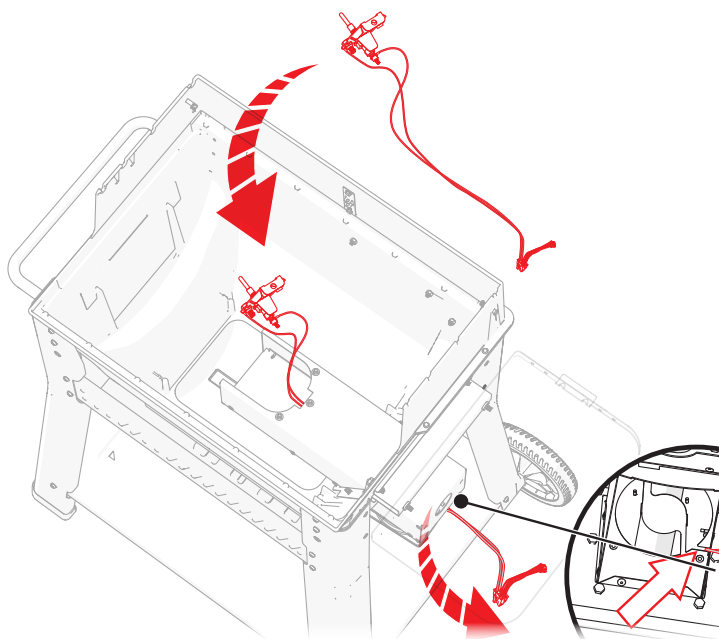
**35**

THERMOCOUPLE RE-INSTALLATION

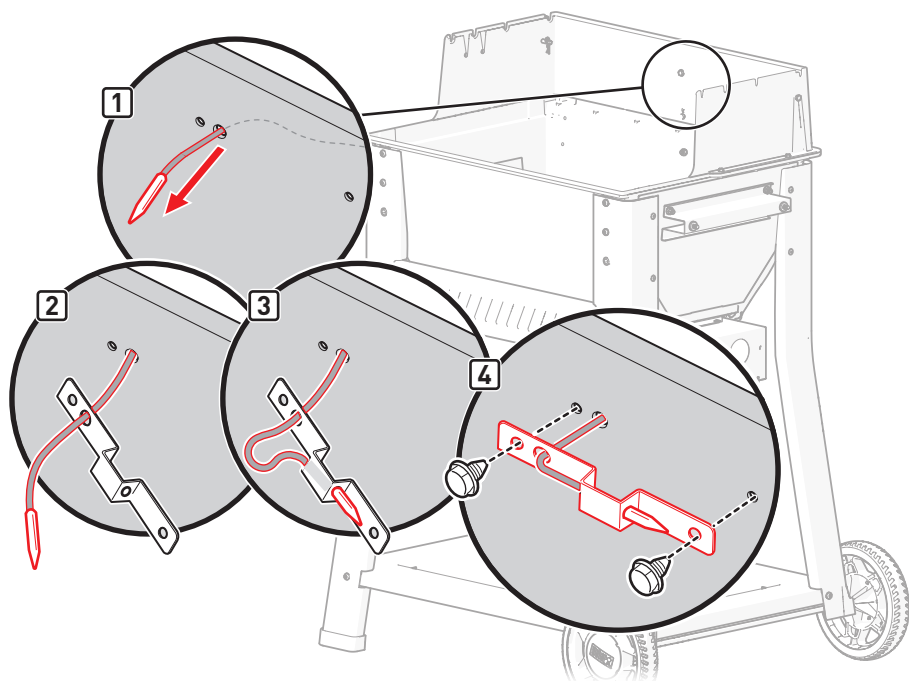

⚠ CAUTION: CAREFULLY ROUTE THE CONNECTOR(S) THROUGH THE HOLES, DO NOT DAMAGE THE PLUG OR WIRES WHILE ROUTING INTO THE GRILL.

36

HOPPER RE-INSTALLATION

⚠ CAUTION: BEFORE SECURING THE HOPPER TO THE COOKBOX, SLIDE THE WIRES BACK THROUGH THE HOLES ON THE REAR OF THE HOPPER.

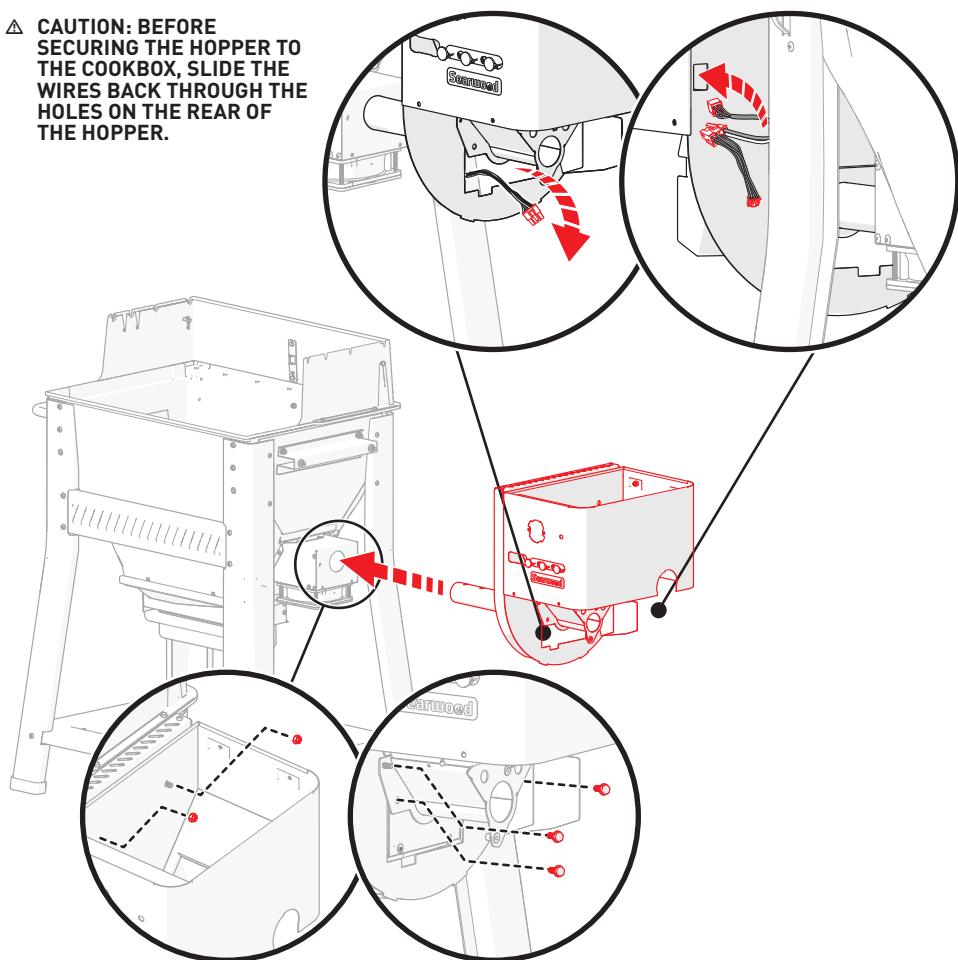

⚠ BEFORE FULLY TIGHTENING THE SCREWS, PULL ANY OF THE EXTRA WIRES INTO THE HOPPER AREA. DO NOT CRUSH OR KINK ANY OF THE WIRES.

37

HOPPER ACCESS DOOR RE-INSTALLATION

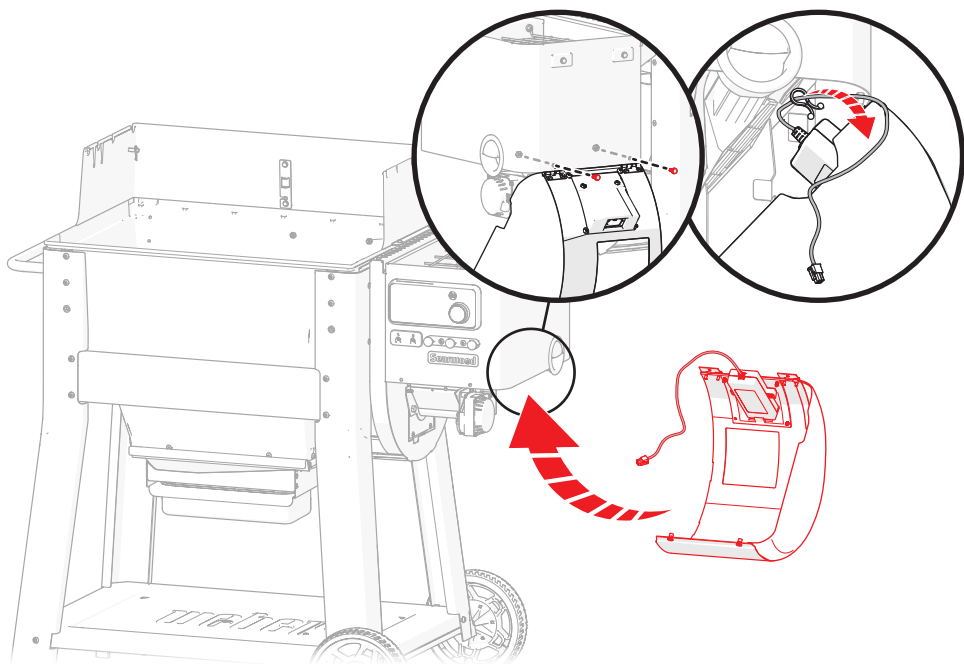
**38**

FERRITE CLAMP RE-INSTALLATION

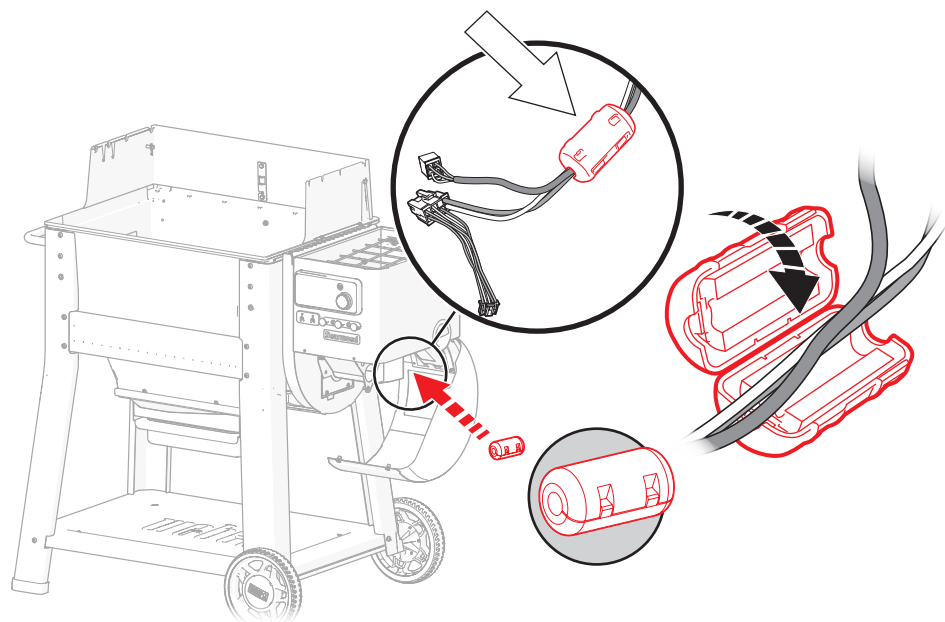

AUGER ASSEMBLY RE-INSTALLATION

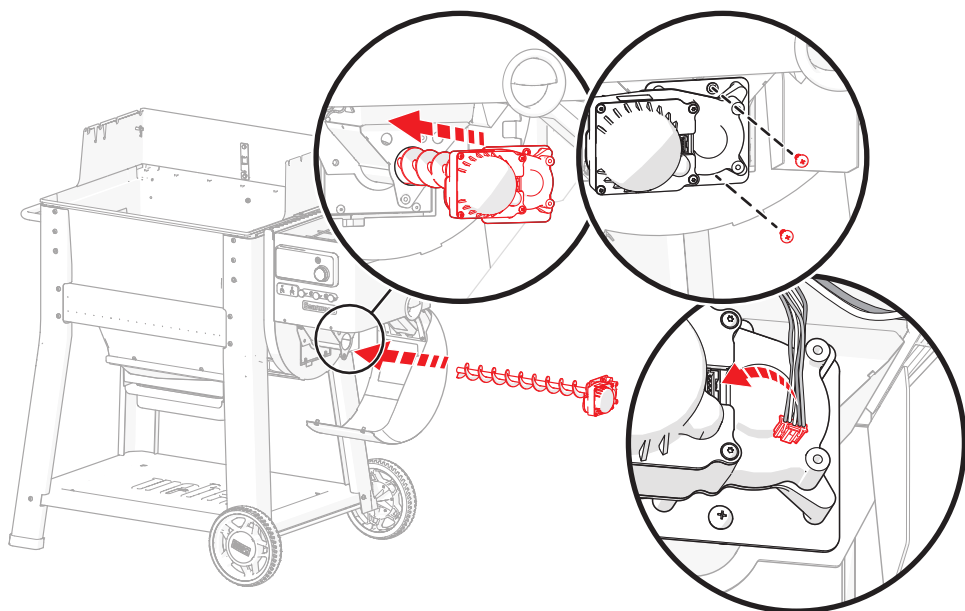

⚠ CAUTION: CAREFULLY PLUG IN THE CONNECTOR(S), DO NOT DAMAGE THE PLUG WHEN RECONNECTING IT TO THE GRILL.

40

CIRCUIT BOARD CONNECTIONS:

- | | | |
|-----------------------|----------------------------|----------------------------|
| 1: UGC USBC Connector | 3: Probe Hub & Fuel Sensor | 5: Auger Motor & Glow Plug |
| 2: Thermocouple | 4: Fan | 6: Power Supply |

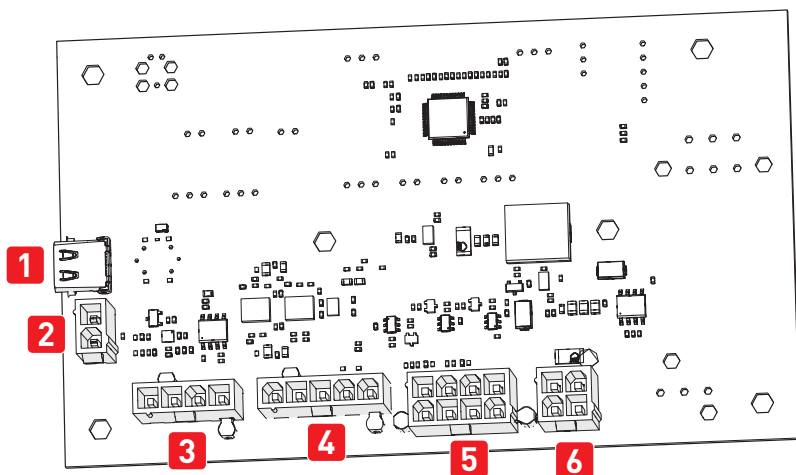

41

PLUG IN CIRCUIT BOARD

⚠ CAUTION: CAREFULLY PLUG IN THE CONNECTOR(S), DO NOT DAMAGE THE PLUG WHEN RECONNECTING IT TO THE GRILL.

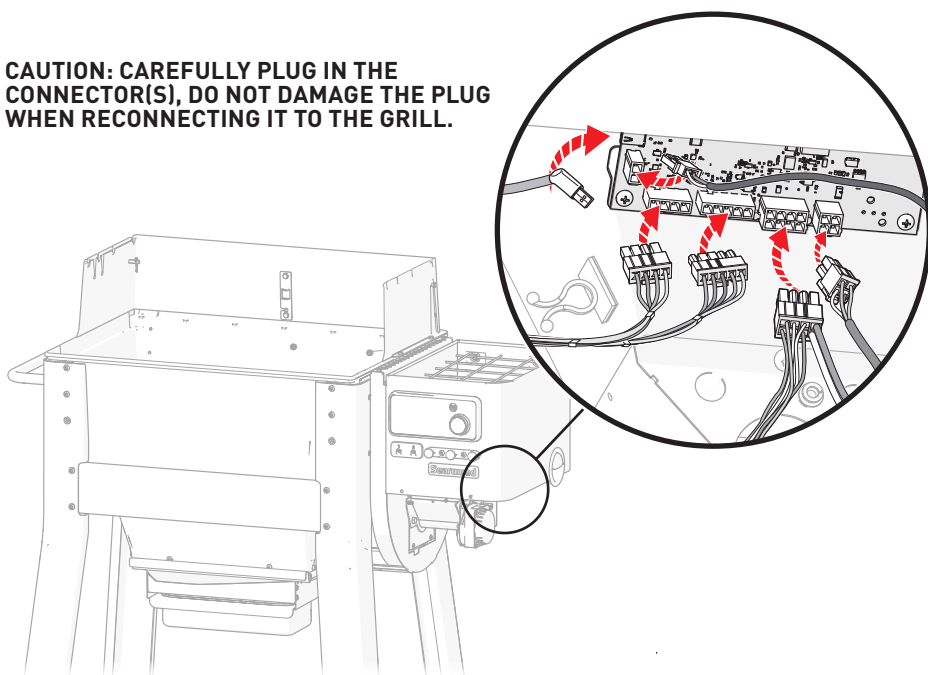

42

SECURE ALL WIRES

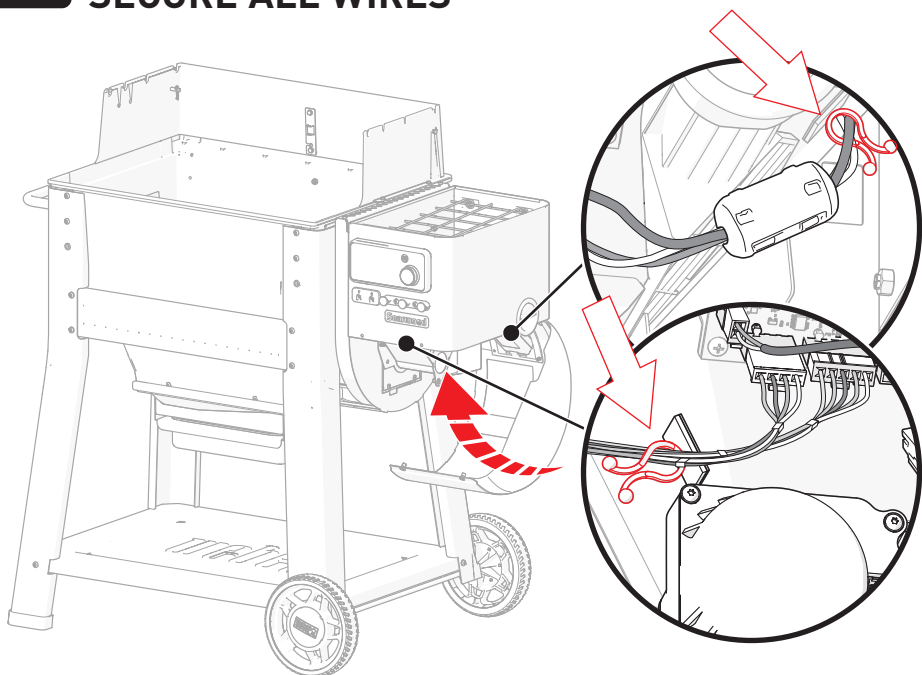
**43**

CLOSE HOPPER ACCESS DOOR

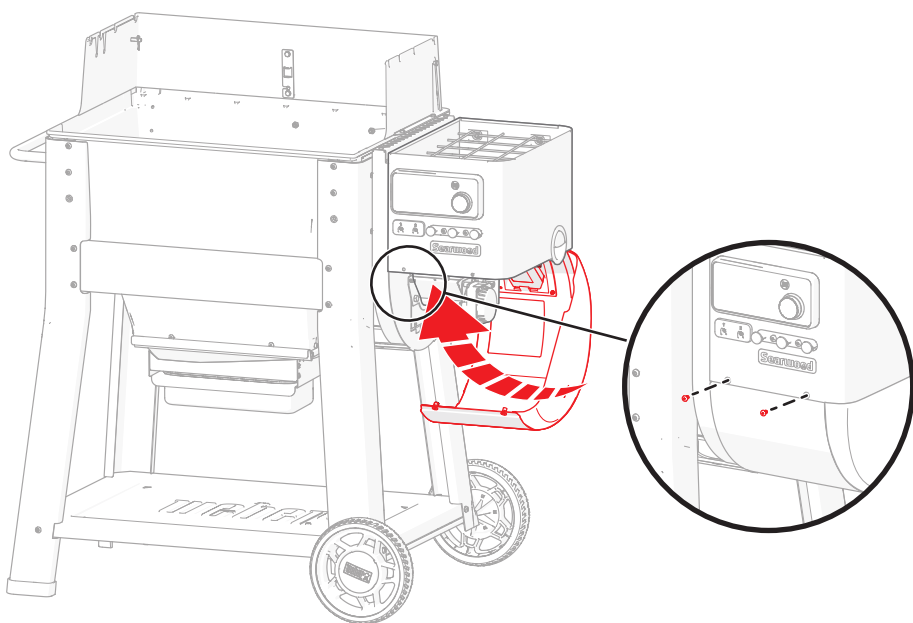

44

HOPPER LID RE-INSTALLATION

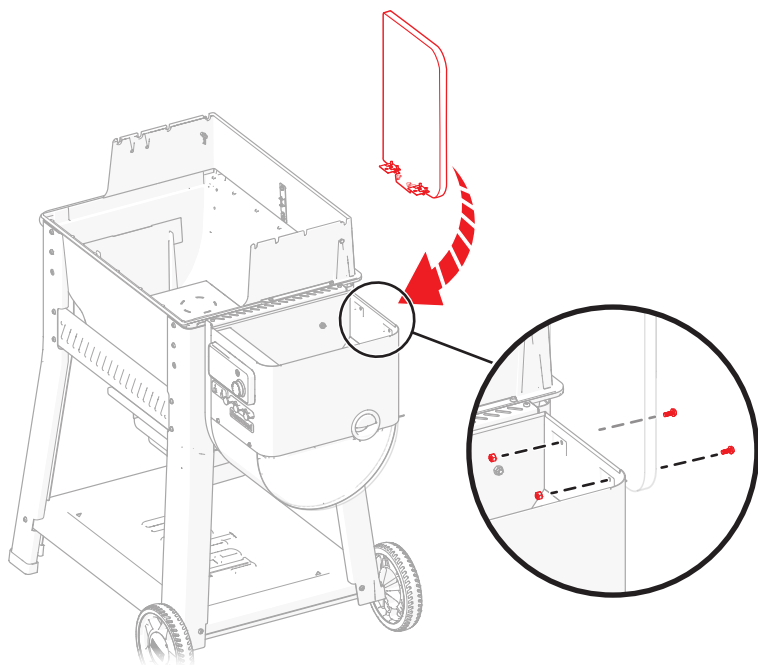
**45**

FINGER GUARD RE-INSTALLATION

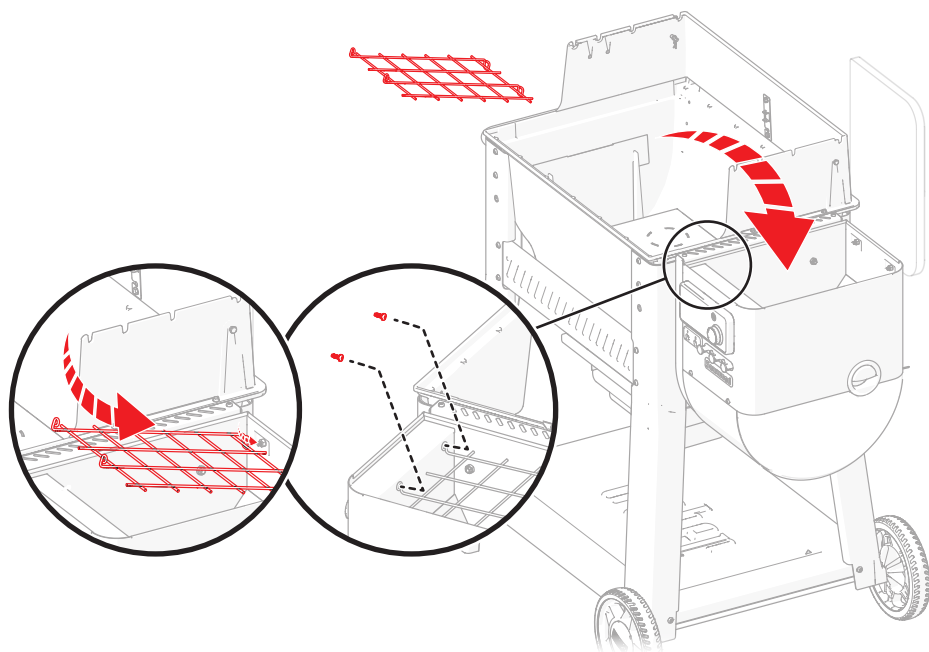

46

CONTROLLER RE-INSTALLATION

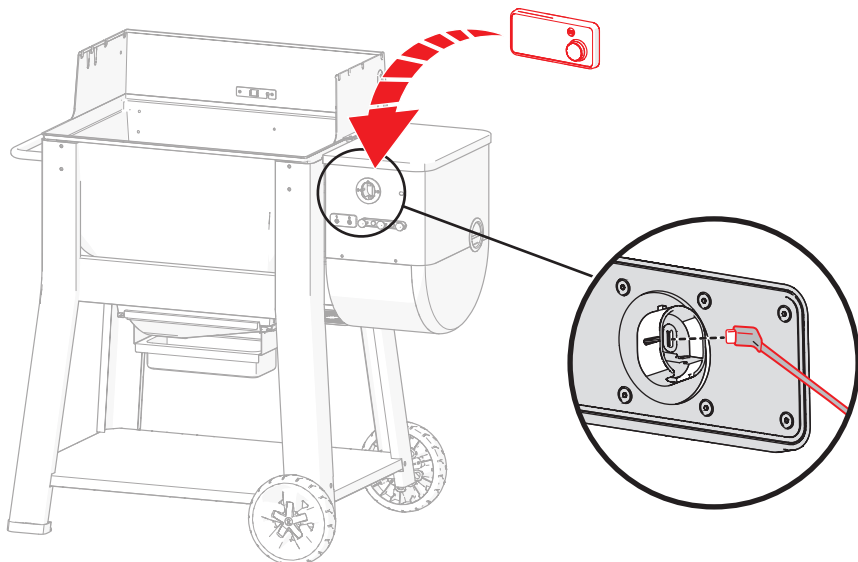
**47**

CONNECT GLOW PLUG BRACKET

- Slide the glow plug assembly and align the bracket to the auger chute

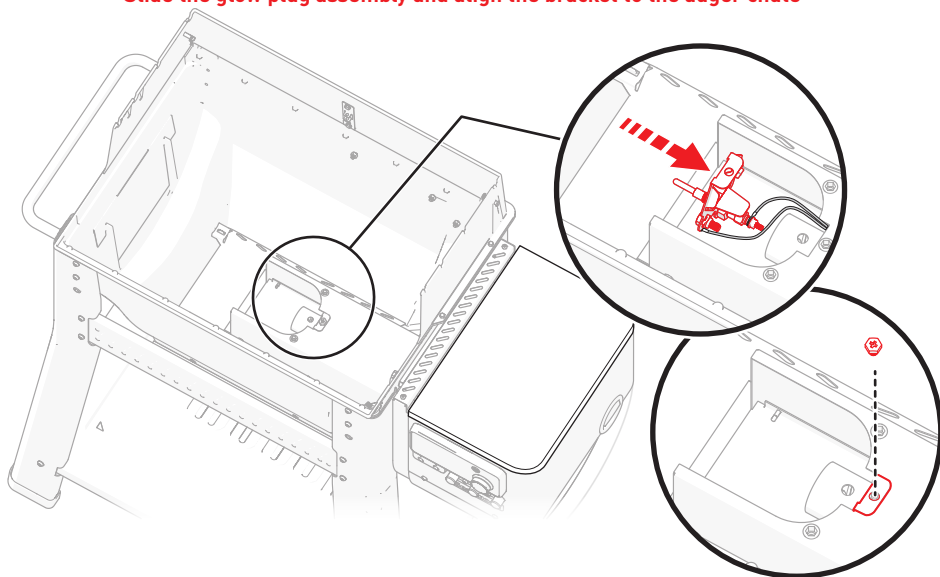

48

BURN POT RE-INSTALLATION

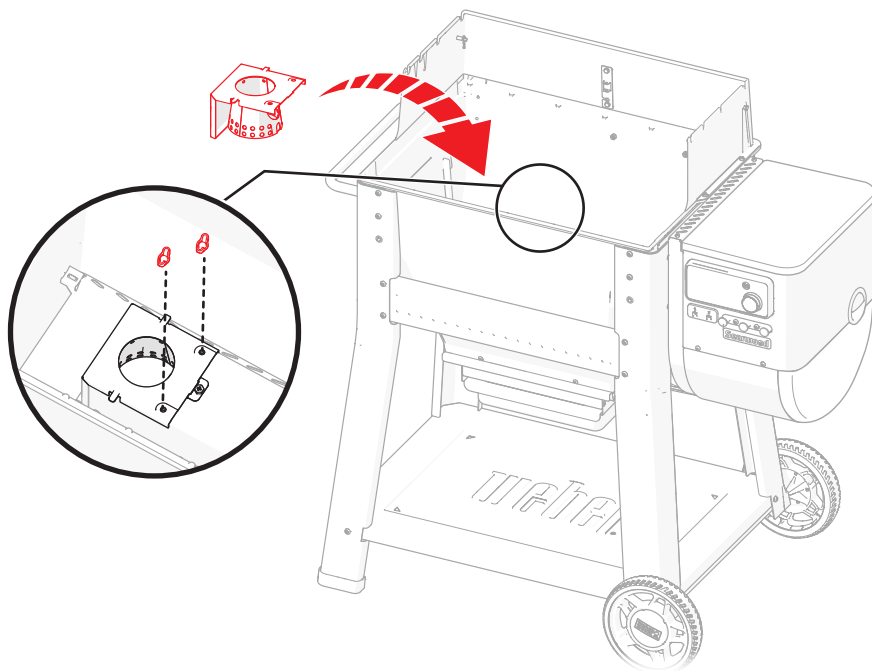

49

COOKBOX COMPONENTS RE-INSTALLATION

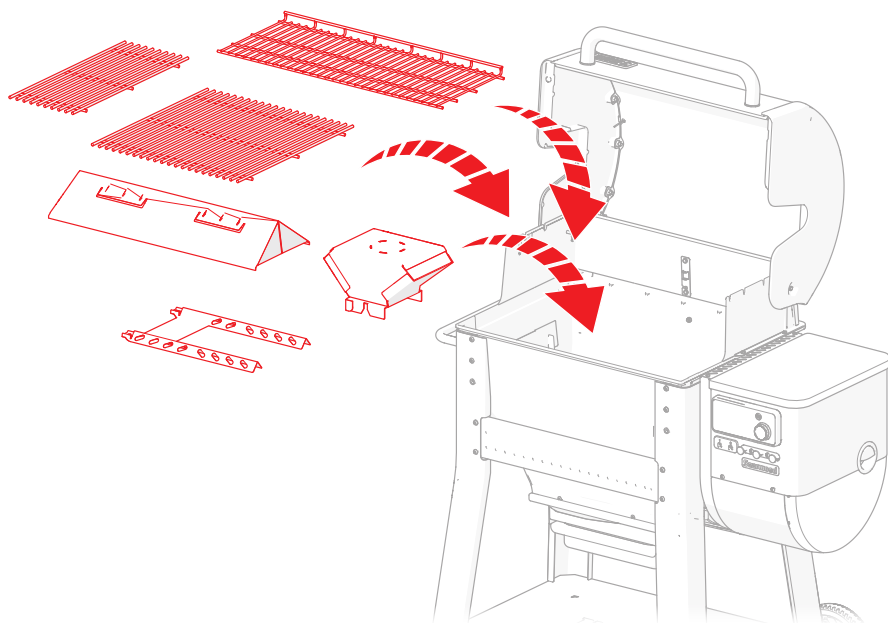

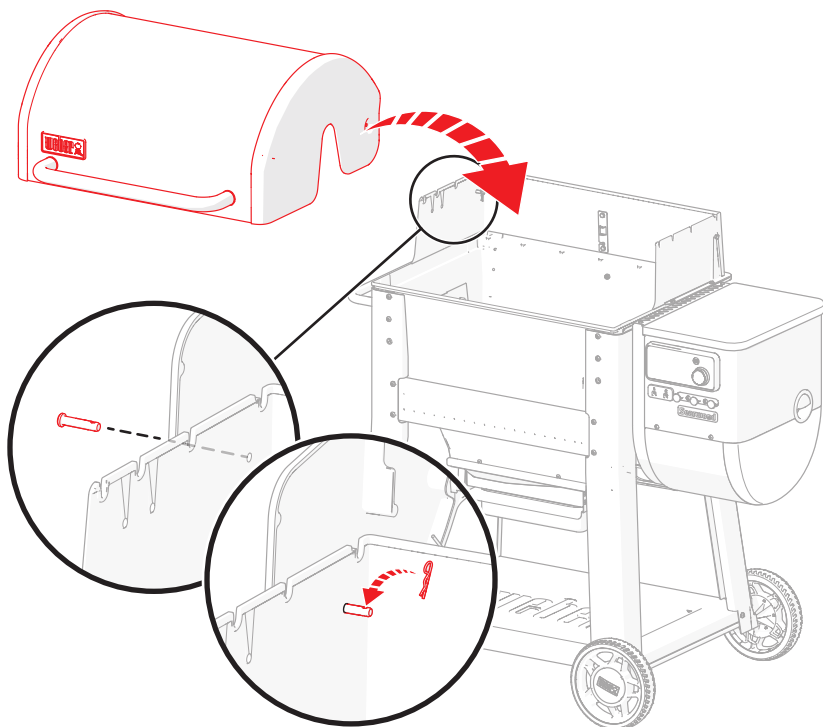

⚠ WARNING: Make sure all parts are assembled and hardware is fully tightened before operating the grill. Your actions, if you fail to follow this product warning, may cause a fire, an explosion, or structural failure resulting in serious personal injury or death as well as damage to property.

UNITED STATES ONLY

⚠ PROPOSITION 65 Warning: Handling the brass material on this product exposes you to lead, a chemical known to the state of California to cause cancer, birth defects or other reproductive harm.

(Wash hands after handling this product.)

ES **⚠ Propuesta 65 Advertencia:** El manipular los materiales de latón en este producto lo exponen al plomo, una sustancia química conocida por el estado de California como causante de cáncer, de defectos de nacimiento o de otros daños reproductivos.

(Lávese las manos después de manipular este producto.)

FR **⚠ Proposition 65 Mise en garde :** La manipulation du matériau en cuivre contenu dans ce produit vous expose au plomb, agent chimique reconnu par l'état de Californie comme étant à l'origine de cancers, d'anomalies congénitales ou d'autres troubles de la reproduction.

(Lavez-vous les mains après avoir manipulé ce produit.)

⚠ ATTENTION: This product has been safety-tested and is only certified for use in a specific country. Refer to country designation located on outside of box.

These parts may be gas-carrying or gas-burning components. Please contact Weber-Stephen Products LLC Customer Service Department for genuine Weber-Stephen Products LLC replacement part(s) information.



⚠ WARNING: Do not attempt to make any repair to gas-carrying or gas-burning components without contacting Weber-Stephen Products LLC Customer Service Department. Your actions, if you fail to follow this product warning, may cause a fire or an explosion resulting in serious personal injury or death and damage to property.

This symbol indicates that the product cannot be disposed of with household refuse. For instructions regarding proper disposal of this product in Europe, please visit www.weber.com, and contact the importer listed for your country. If you do not have internet access, contact your dealer for the importer's name, address and telephone number.

When you decide to dispose of or discard your grill, all electrical components (e.g., rotisserie motor, batteries, ignition module, handle lights) must be removed and disposed of properly according to WEEE. They should be disposed of separately from the grill.



AUSTRIA

Weber-Stephen Österreich GmbH
+43 (0)7 242 89 0135
service-at@weber.com

BELGIUM

Weber-Stephen Products Belgium Sprl
+32 15 28 30 99
service-be@weber.com

CHILE

Weber-Stephen Chile SpA.
+01 56 2-3224-3936

CZECH REPUBLIC

Weber-Stephen CZ & SK spol. s r.o.
+420 228 882 385
service-cz@weber.com

DENMARK

Weber-Stephen Nordic ApS
+45 99 36 30 10
service-dk@weber.com

FRANCE

Weber-Stephen France SAS
+33 0810 19 32 37
service-fr@weber.com

GERMANY

Weber-Stephen Deutschland GmbH
+49 (0) 30 219 0710
service-de@weber.com

ICELAND

Jarn & Gler Wholesale EHF
+354 58 58 900

INDIA

Weber-Stephen Grill Products India Pvt. Ltd.
080 42406666
customer@weberindia.com

ITALY

Weber-Stephen Products Italia Srl
+39 0444 367 911
service-it@weber.com

NETHERLANDS

Weber-Stephen Holland B.V.
+31 (0) 513 4 333 22
service-nl@weber.com

POLAND

Weber-Stephen Polska Sp. z o.o.
+48 22 392 04 69
info-pl@weberstephen.com

RUSSIA

Weber-Stephen Vostok LLC
+7 495 956 63 21
info.ru@weberstephen.com

SOUTH AFRICA

Weber-Stephen Products (South Africa) Pty Ltd.
+27 11 454 2369
info@weber.co.za

SPAIN

Weber-Stephen Ibérica SRL
+34 935 844 055
service-es@weber.com

SWITZERLAND

Weber-Stephen Schweiz GmbH
+41 52 24402 50
service-ch@weber.com

UNITED ARAB EMIRATES

Weber-Stephen Deutschland GmbH, Dubai Branch
+971 4 454 1626
info@weberstephen.ae

UNITED KINGDOM

Weber-Stephen Products (UK) Ltd.
+44 (0)203 630 1500
service-uk@weber.com

USA

Weber-Stephen Products LLC
847 934 5700
support@weberstephen.com

For Republic of Ireland, please contact:
Weber-Stephen Products (U.K.) Limited.

For other Eastern European countries, such as ROMANIA, SLOVENIA, CROATIA or GREECE, please contact:
Weber-Stephen Deutschland GmbH.

For Baltic states, please contact:
Weber-Stephen Nordic ApS.



WEBER-STEPHEN PRODUCTS LLC

www.weber.com

© 2023 Designed and engineered by Weber-Stephen Products LLC,
1415 S. Roselle Road, Palatine, Illinois 60067 USA.

WEBER-STEPHEN PRODUCTS LLC
Customer Service Center: 1415 S. Roselle Road, Palatine, Illinois 60067 USA

1-800-446-1071 (U.S.A. ONLY)