



Summit

BULKHEAD ASSEMBLY / HOSE AND REGULATOR REPLACEMENT INSTRUCTIONS

THIS PROCEDURE SHOULD ONLY BE PERFORMED BY AN AUTHORIZED
WEBER-STEPHEN PRODUCTS LLC SERVICE TECHNICIAN

⚠ WARNING: GENUINE WEBER-STEPHEN REPLACEMENT PARTS MUST BE USED FOR ANY REPAIR OR REPLACEMENT. YOUR ACTIONS, IF YOU FAIL TO FOLLOW THIS PRODUCT WARNING, MAY CAUSE A FIRE, AN EXPLOSION, OR STRUCTURAL FAILURE RESULTING IN SERIOUS PERSONAL INJURY OR DEATH AS WELL AS DAMAGE TO PROPERTY. (WILL VOID ALL WARRANTY PROTECTION.)

⚠ DANGER: BEFORE PERFORMING ANY WORK MAKE SURE THE GAS SUPPLY IS TURNED OFF AT THE SOURCE. FAILURE TO FOLLOW DANGERS, WARNINGS AND CAUTIONS CONTAINED IN THIS INSTRUCTION SHEET MAY CAUSE A FIRE OR AN EXPLOSION RESULTING IN SERIOUS PERSONAL INJURY OR DEATH AS WELL AS DAMAGE TO PROPERTY.

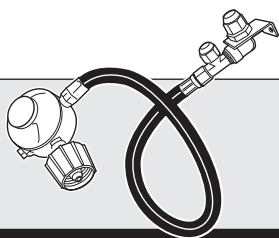

**LP BULKHEAD
ASSEMBLY
REPLACEMENT**

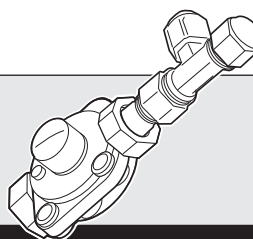

**NG BULKHEAD
ASSEMBLY
REPLACEMENT**

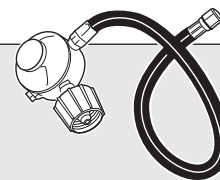

**HOSE AND
REGULATOR
REPLACEMENT**

⚠ BEFORE STARTING:
Make sure lid is closed
and casters are locked to
prevent grill from moving.

1

DISCONNECTION OF GAS SOURCE

- A) Make sure main gas source is completely turned off.
B) Disconnect main corrugated gas line attached to bulkhead fitting, which is located inside tank enclosure (1).

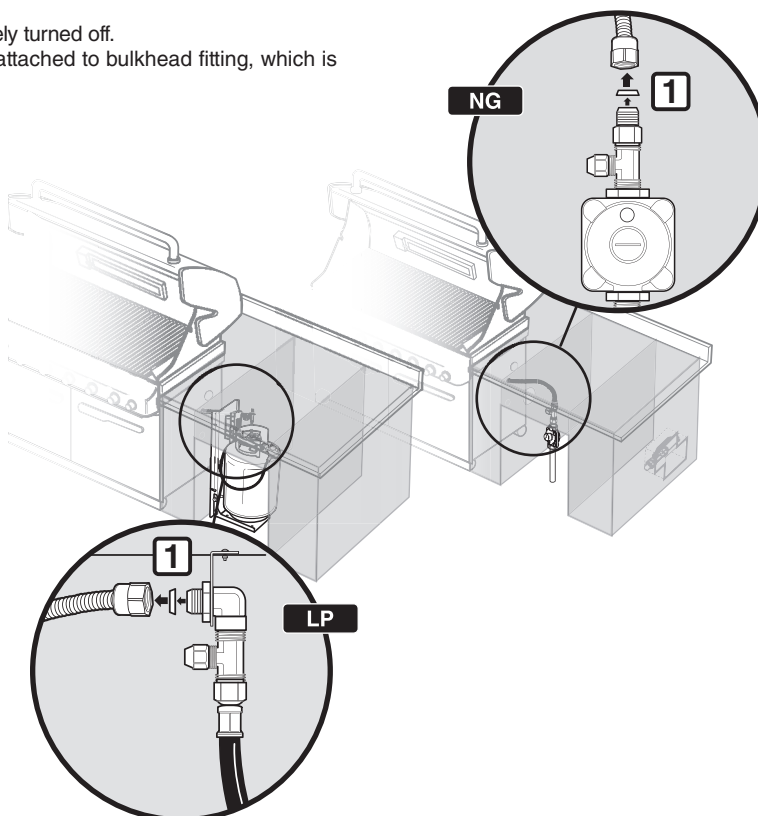

NOTE: Grills illustrated may have slight differences than model purchased.

2

BULKHEAD ASSEMBLY REMOVAL

LP Units:

- Remove screws and washers that secure bulkhead assembly to top of built-in tank enclosure.
- Pull bulkhead assembly out of tank enclosure.

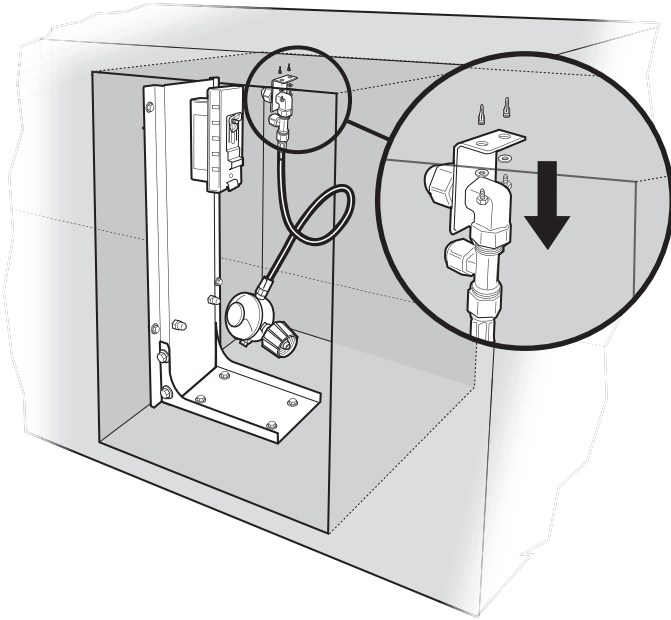

NG Units:

- Disconnect bulkhead assembly from natural gas hose fitting.
- Pull bulkhead assembly out of tank enclosure.

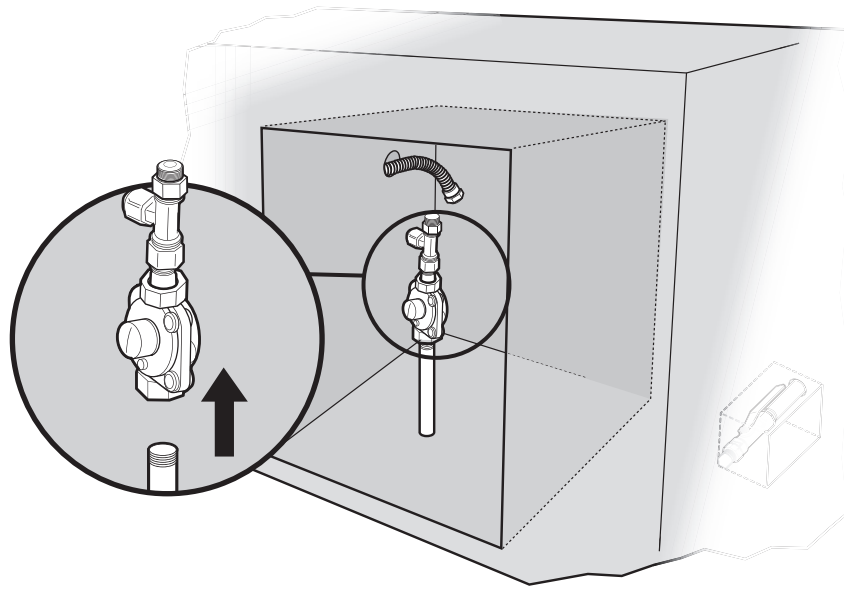

• REPLACEMENT PART INSTALLATION

3

BULKHEAD ASSEMBLY INSTALLATION

LP Units:

- Place bulkhead assembly into tank enclosure.
- Install screws and washers that secure bulkhead assembly to top of built-in tank enclosure.

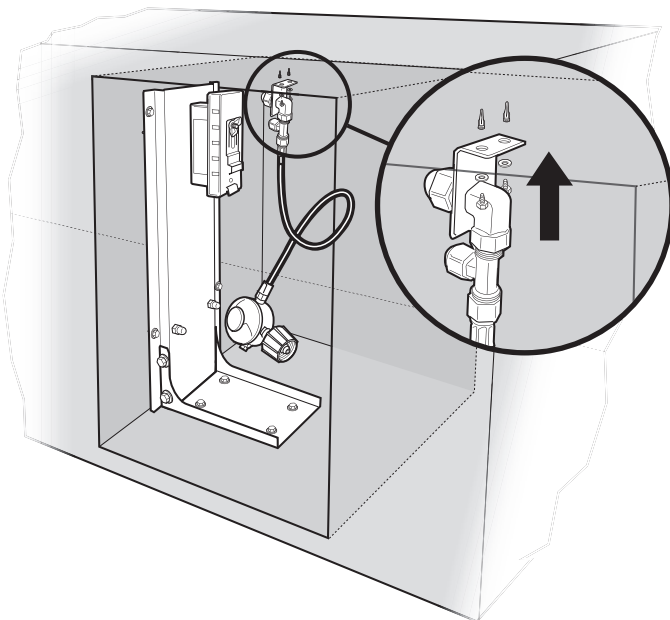

NG Units:

- Place bulkhead assembly into tank enclosure.
- Connect bulkhead assembly to natural gas hose fitting.
DO NOT OVERTIGHTEN BULKHEAD FITTING.

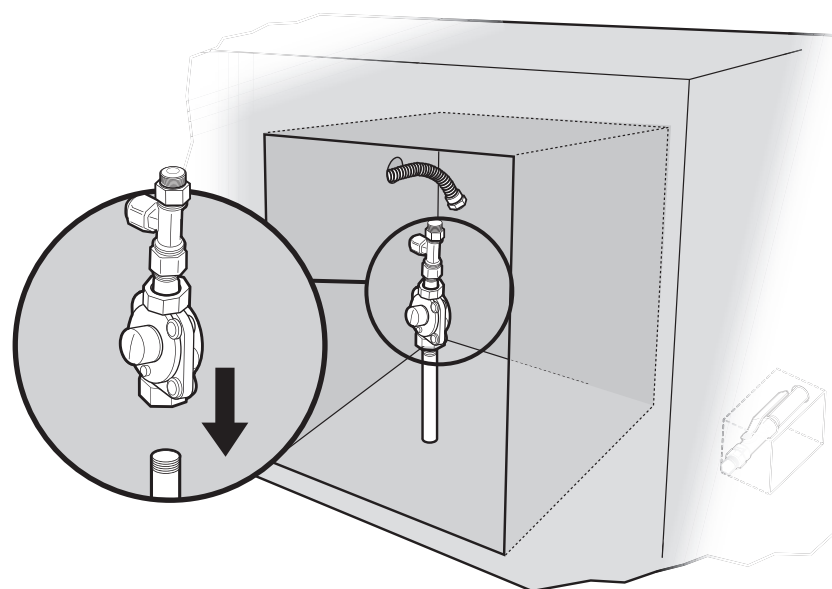

4

HOSE AND REGULATOR INSTALLATION

TOOLS NEEDED:

 - 7/8", 3/4"

- A) Connect hose and regulator to bulkhead assembly (1) by using a 7/8" wrench or adjustable wrench to hold bulkhead fitting in place, and a 3/4" wrench on hose and regulator fitting. Turn regulator fitting until tight to bulkhead assembly.

DO NOT OVERTIGHTEN REGULATOR FITTING.

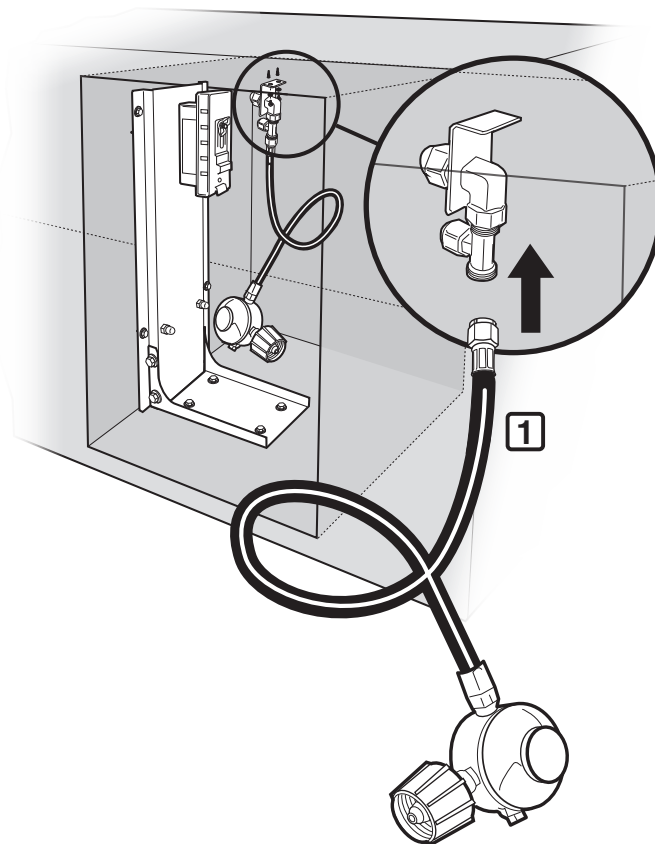

5

CONNECTION OF GAS SOURCE

- A) Make sure main gas source is completely turned off.
 B) Pull main corrugated gas line through grill assembly into island structure cavity. (Not Pictured)
 C) Connect main corrugated gas line to bulkhead fitting, which is located inside tank enclosure (1).

DO NOT OVERTIGHTEN GAS LINE FITTING.

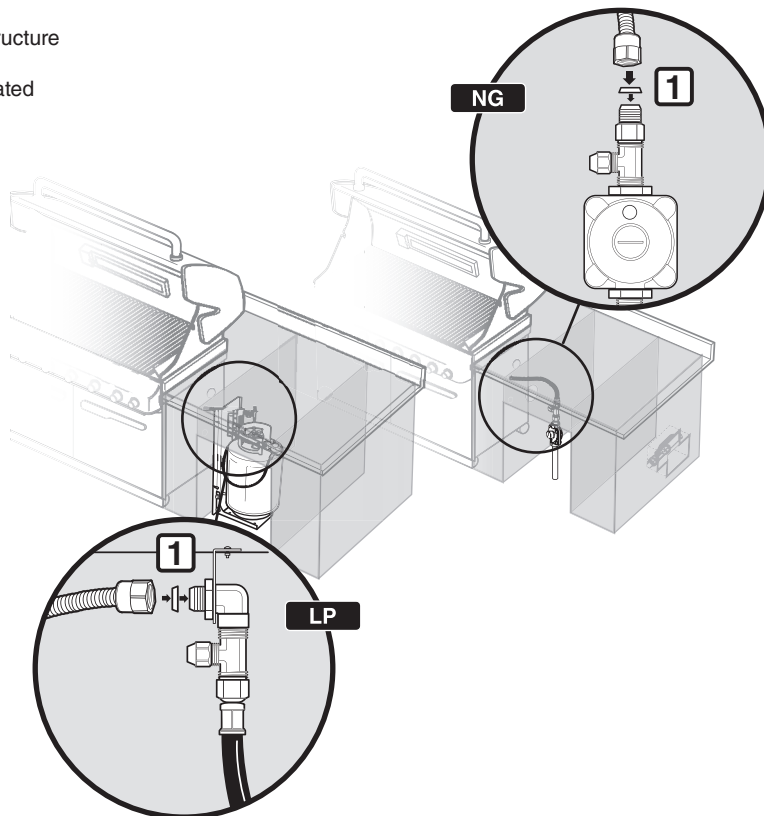

⚠ WARNING: Make sure all control knobs are turned to the OFF position before reconnecting gas supply and operating grill. Your actions, if you fail to follow this Product Warning, may cause a fire, an explosion, or structural failure resulting in serious personal injury or death as well as damage to property.

6

CHECK FOR GAS LEAKS

⚠ DANGER

Do not use an open flame to check for gas leaks. Be sure there are no sparks or open flames in the area while you check for leaks. Sparks or open flames will result in a fire or explosion, which can cause serious bodily injury or death and damage to property.

You will need: a soap and water solution and a rag or brush to apply it.

- A) Mix soap and water.
- B) Turn on gas supply at source.
- C) Check for leaks by wetting fittings with soap and water solution and watching for bubbles. If bubbles form, or if a bubble grows, there is a leak.
- D) When leak checking is complete, turn gas supply off at the source and rinse connections with water.

Check:

- A) LP: Corrugated gas line-to-bulkhead connection (1).
- B) Bulkhead-to-gas supply hose connection (2) (5).
- C) Bulkhead-to-regulator connection (6).
- D) NG: Regulator-to-gas supply connection (7).

⚠ DANGER: If there is a leak at connection (1, 2, 5, 6 or 7), retighten the fitting with a wrench and recheck for leaks with soap and water solution. If a leak persists, turn OFF the gas. **DO NOT OPERATE THE GRILL.** Failure to follow dangers, warnings and cautions contained in this Instruction sheet may cause a fire or an explosion resulting in serious personal injury or death as well as damage to property. Contact the Customer Service Representative in your area using the contact information on our web site. Log onto www.weber.com.

- E) LP: Hose-to-regulator connection (3).
- F) LP: Regulator-to-cylinder connection (4).
- G) NG: Gas supply-to-shutoff connections (8).

⚠ DANGER: If there is a leak at connection (3, 4 or 8), turn off the gas. **DO NOT OPERATE THE GRILL.** Failure to follow dangers, warnings and cautions contained in this Instruction sheet may cause a fire or an explosion resulting in serious personal injury or death as well as damage to property. Contact the Customer Service Representative in your area using the contact information on our web site. Log onto www.weber.com.

When leak checks are complete, turn gas supply OFF at the source and rinse connections with water.

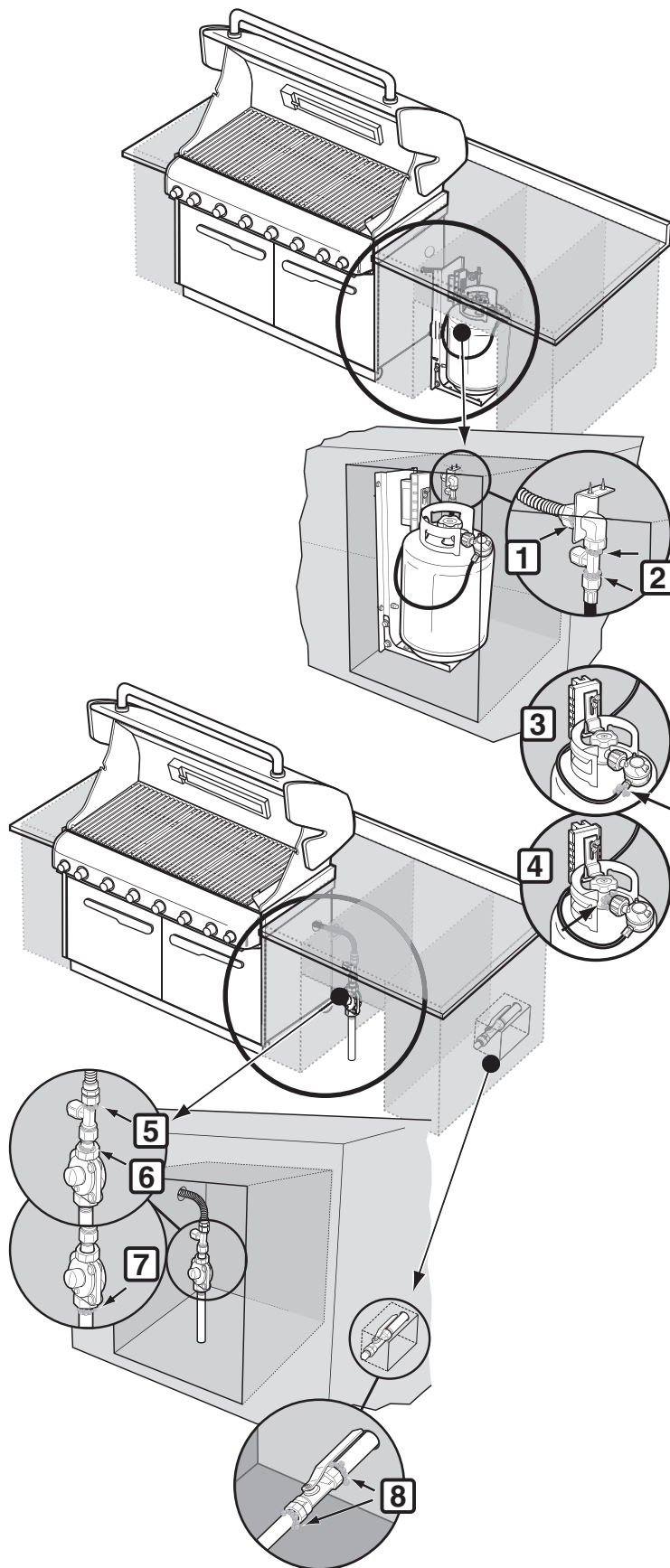

⚠ WARNING: Make sure all parts are assembled and hardware is fully tightened before operating the grill. Your actions, if you fail to follow this product warning, may cause a fire, an explosion, or structural failure resulting in serious personal injury or death as well as damage to property.

⚠ PROPOSITION 65 WARNING: HANDLING THE BRASS MATERIAL ON THIS PRODUCT EXPOSES YOU TO LEAD, A CHEMICAL KNOWN TO THE STATE OF CALIFORNIA TO CAUSE CANCER, BIRTH DEFECTS OR OTHER REPRODUCTIVE HARM.

(WASH HANDS AFTER HANDLING THIS PRODUCT.)

⚠ WARNING: All repairs to gas carrying, gas burning, igniter or structural components must be performed by an authorized Weber-Stephen Products LLC service technician.

These parts may be gas carrying, gas burning, igniter or structural components. Please contact Weber-Stephen Products LLC, Customer Service Department for Genuine Weber-Stephen Products LLC replacement part(s) information.

⚠ WARNING: Do not attempt to make any repair to gas carrying, gas burning, igniter or structural components without contacting Weber-Stephen Products LLC, Customer Service Department. Your actions, if you fail to follow this Product Warning, may cause a fire, an explosion, or structural failure resulting in serious personal injury or death as well as damage to property.

NOTES

This image shows a single sheet of white paper with horizontal ruling lines. The lines are evenly spaced and run across the width of the page. There are no margins, text, or other markings on the paper.

Visit



WEBER-STEPHEN PRODUCTS LLC
www.weber.com[®]

For All of Your Grilling Needs



WEBER-STEPHEN PRODUCTS LLC
Customer Service Center
1890 Roselle Road, Suite 308
Schaumburg, IL 60195

1-800-446-1071 (USA ONLY)
www.weber.com